

Residential Dock Reconstruction at 633 Via Lido Soud

Harbor Commission
July 14, 2021



Disclaimer:
Every reasonable effort has been made to assure the accuracy of the data provided, however, The City of Newport Beach and its employees and agents disclaim any and all responsibility from or relating to any results obtained in its use.



NBGiS
NEWPORT BEACH



0 100 200
Feet

Disclaimer:
Every reasonable effort has been made to assure the accuracy of the data provided, however, The City of Newport Beach and its employees and agents disclaim any and all responsibility from or relating to any results obtained in its use.

7/7/2021

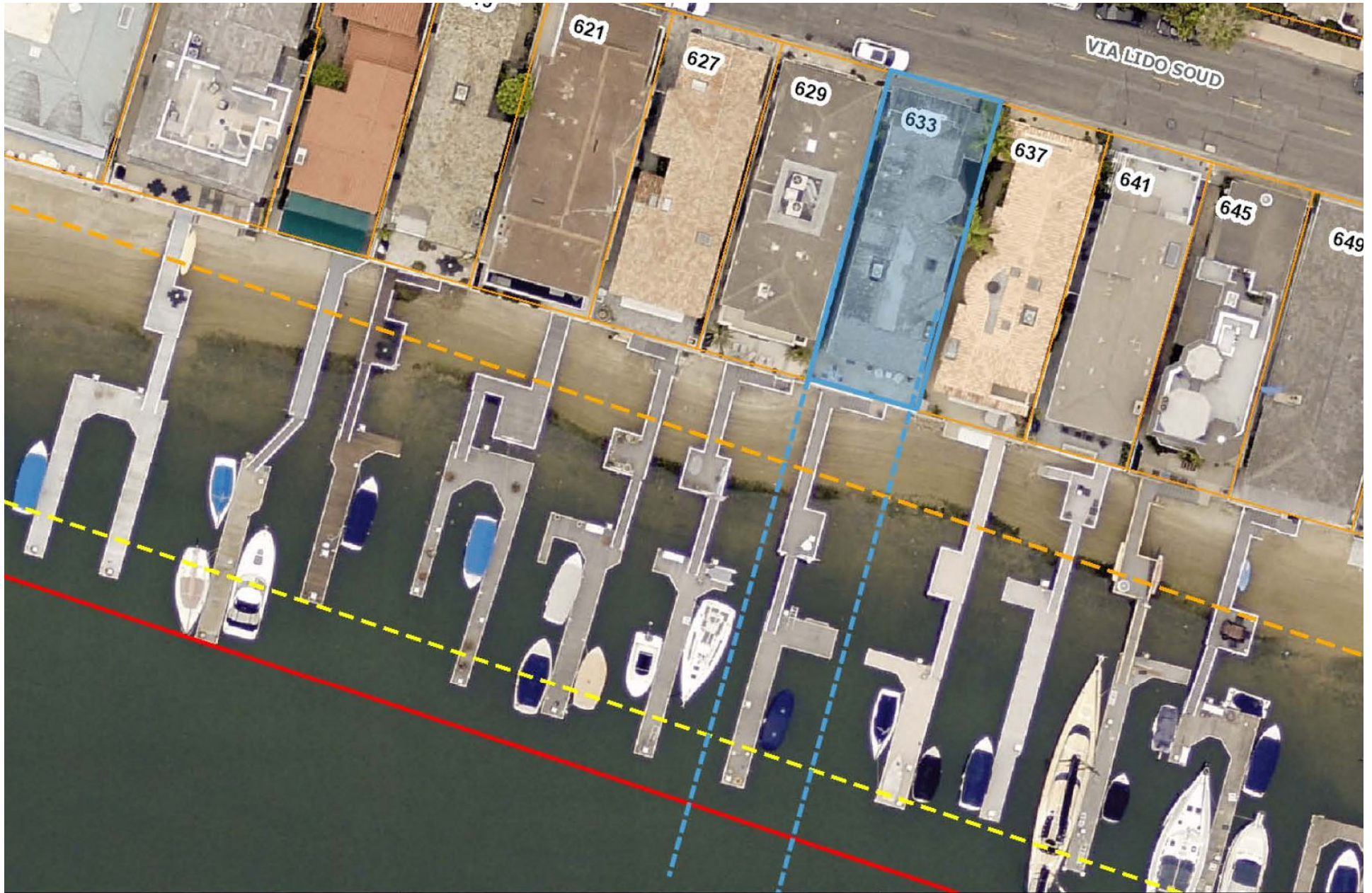

NBGiS
NEWPORT BEACH



0 40 80
Feet

Disclaimer:
Every reasonable effort has been made to assure the accuracy of the data provided, however, The City of Newport Beach and its employees and agents disclaim any and all responsibility from or relating to any results obtained in its use.

CITY OF NEWPORT BEACH

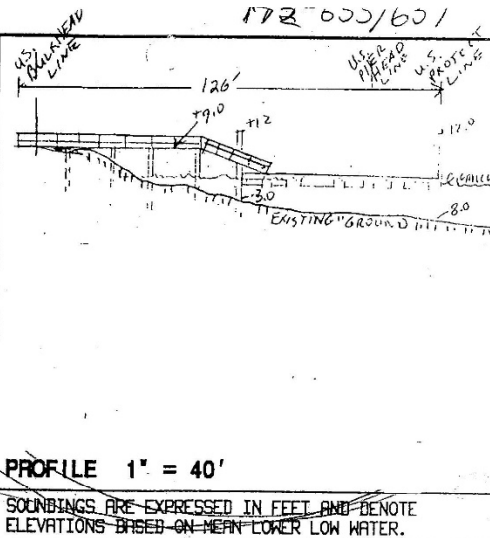
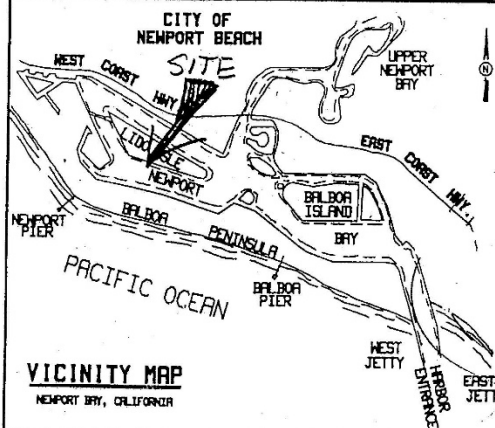

*Scope of Work:
Redeck pier, Gangway
& Float. Like for like
No configuration change
& no new pile. Lido*

"633"	"637"
11	12
13	14
ISLAND	
32'	32'

HARBOR RESOURCES DIV.
CITY OF NEWPORT BEACH
Chris M. 8/9/05

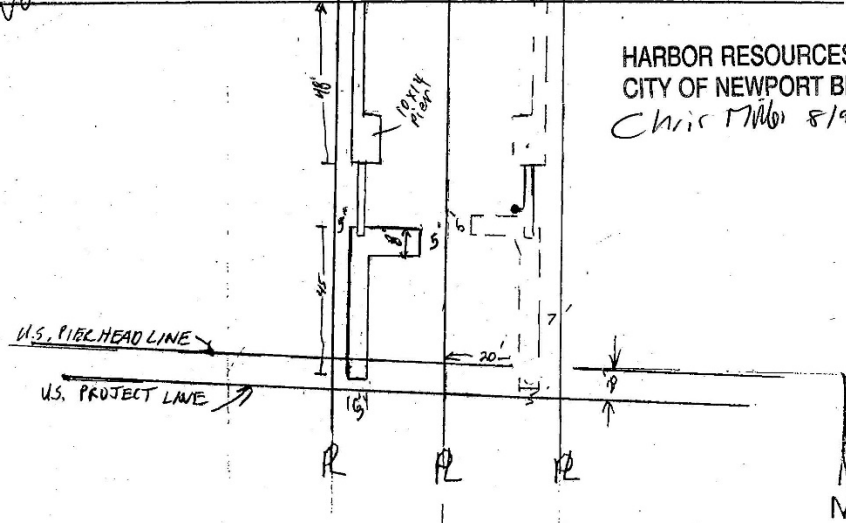

APPLICANT'S NAME **Susan Titus**
Cont. Swift Slip

JOB ADDRESS **633 Via Lido Sound** DATE **8-8-05**
Drawn by: *Emily Hill*



SWIFT SLIP DOCK & PIER BUILDERS, INC.

6351 Industry Way, Westminster, CA 92683
Phone: (949) 631-3121
Fax: (714) 509-0618
www.swiftslipdocks.com

CLIENT

TEAM, DAVID

RO
DRAWN

CHECKED

1.0
REVISION

12/17/20
DATE

AMENDMENTS:

REV.	DESCRIPTION:	BY:	DATE:
-	----	-	-
-	----	-	-
-	----	-	-

SITE

633 VIA LIDO SOUD, NEWPORT BEACH, CA 92663

DOCK AREA:	
TOTAL AREA	412 FT ²
GANGWAY AREA:	
3' X 22'	66 FT ²
TOTAL	66 FT ²
PIER AREA:	
TOTAL AREA	340 FT ²
TOTAL AREA:	818 FT²

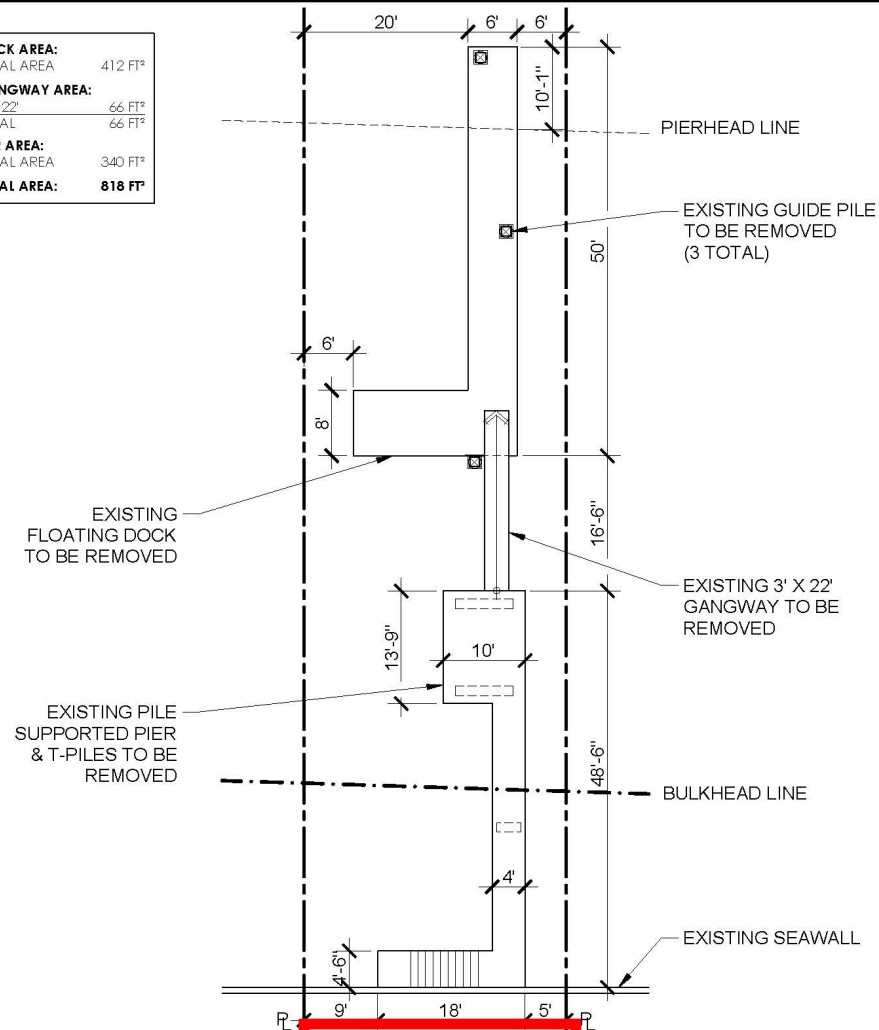

EXISTING



SWIFT SLIP DOCK & PIER BUILDERS, INC.

6351 Industry Way, Westminster, CA 92683
Phone: (949) 631-3121
Fax: (714) 509-0618
www.swiftslipdocks.com

CLIENT

TEAM, DAVID

RO
DRAWN

CHECKED

1.0
REVISION

12/17/20
DATE

AMENDMENTS:

REV.	DESCRIPTION:	BY:	DATE:
-	----	-	-
-	----	-	-
-	----	-	-

SITE

633 VIA LIDO SOUD, NEWPORT BEACH, CA 92663

DOCK AREA:	
TOTAL AREA	351 FT ²
GANGWAY AREA:	
4' X 24'	96 FT ²
TOTAL	96 FT ²
PIER AREA:	
TOTAL AREA	240 FT ²
TOTAL AREA:	687 FT²

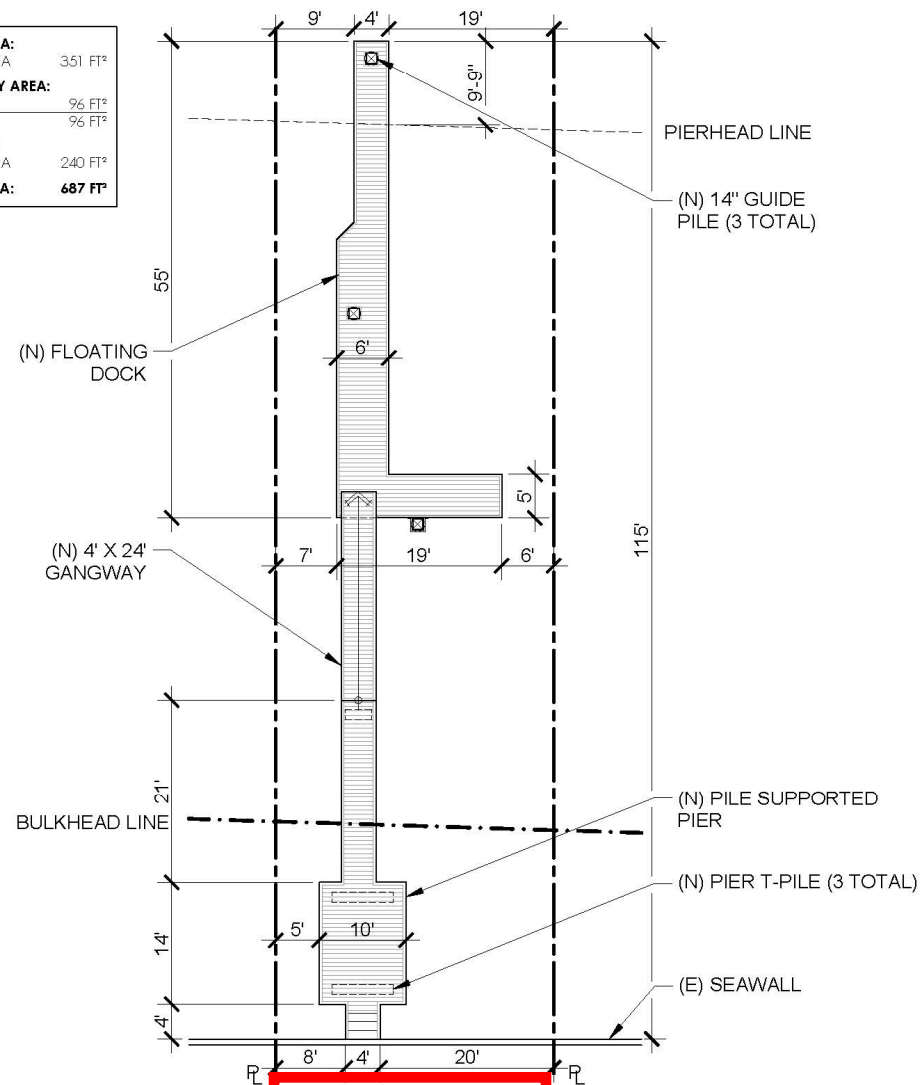

PROPOSED



SWIFT SLIP DOCK & PIER BUILDERS, INC.

6351 Industry Way, Westminster, CA 92683
Phone: (949) 631-3121
Fax: (714) 509-0618
www.swiftslipdocks.com

CLIENT

TEAM, DAVID

RO
DRAWN

CHECKED

1.0
REVISION

12/17/20
DATE

AMENDMENTS:

REV.	DESCRIPTION:	BY:	DATE:
-	----	-	-
-	----	-	-
-	----	-	-

SITE

633 VIA LIDO SOUD, NEWPORT BEACH, CA 92663

LEGEND

EXISTING

DOCK AREA:

TOTAL AREA 412 FT²

GANGWAY AREA:

3' X 22' 66 FT²

TOTAL 66 FT²

PIER AREA:

TOTAL AREA 340 FT²

TOTAL AREA: 818 FT²

PROPOSED

DOCK AREA:

TOTAL AREA 351 FT²

GANGWAY AREA:

4' X 24' 96 FT²

TOTAL 96 FT²

PIER AREA:

TOTAL AREA 240 FT²

TOTAL AREA: 687 FT²

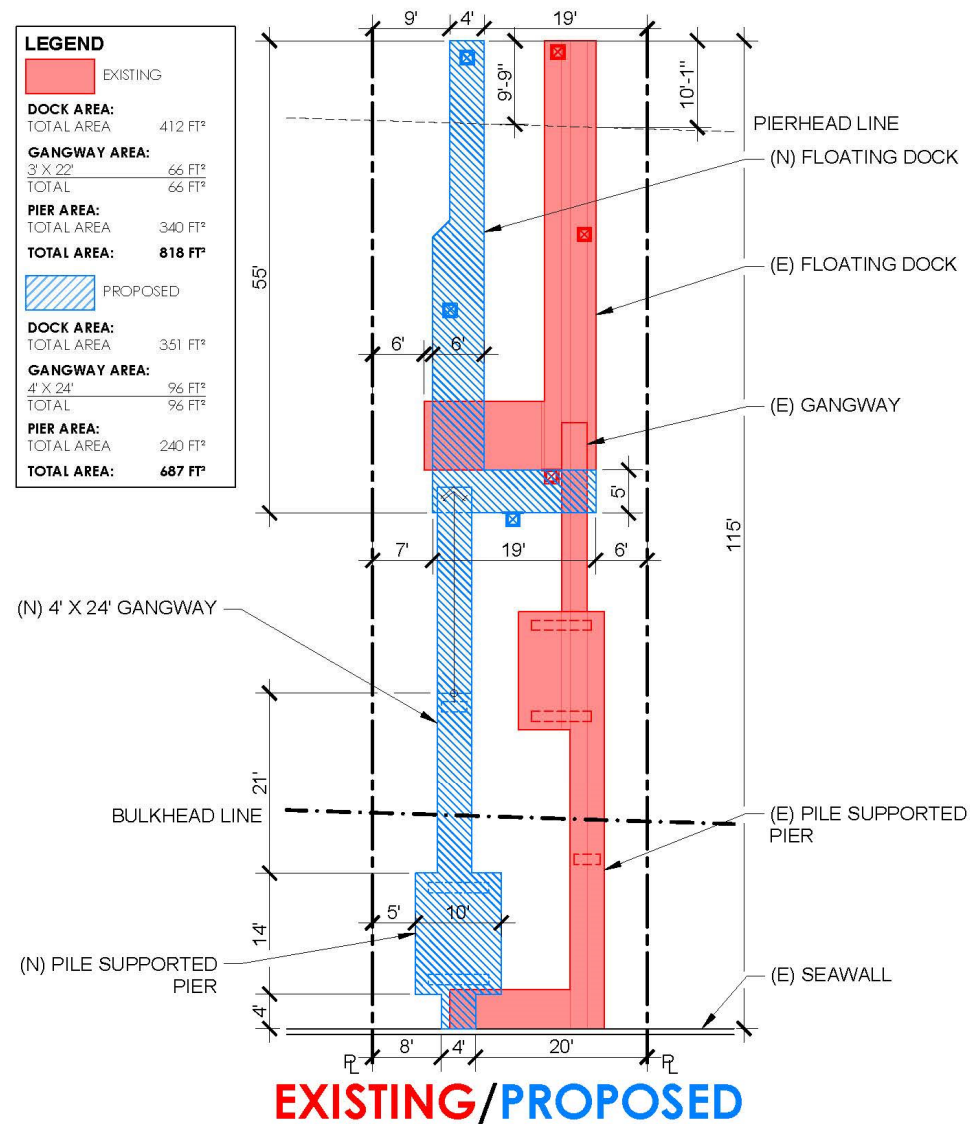



633 Via Lido Soud

- Buffer 300'
- Prolongation of Lot Lines
- 633 Via Lido Soud
- Notified Properties



City of Newport Beach
GIS Division
June 08, 2021

Comments/Questions



Your **Public Works Department**

Protecting and Providing Quality
Public Improvements and Services