



COMMUNITY DEVELOPMENT DEPARTMENT
PLANNING DIVISION

100 Civic Center Drive, P.O. Box 1768, Newport Beach, CA 92658-8915
949-644-3200 Fax: 949-644-3229

www.newportbeachca.gov

**CITY OF NEWPORT BEACH
ZONING ADMINISTRATOR STAFF REPORT**

January 12, 2017
Agenda Item No. 3

SUBJECT: 518 Narcissus Avenue Condominiums (PA2016-189)
518 and 518 ½ Narcissus Avenue
▪ Tentative Parcel Map No. NP2016-025
▪ County Tentative Parcel Map No. 2016-188

APPLICANT: 518 Narcissus LLC

OWNER: 518 Narcissus LLC

PLANNER: Liz Westmoreland, Assistant Planner
(949) 644-3234 lwestmoreland@newportbeachca.gov

ZONING DISTRICT/GENERAL PLAN

- **Zone:** R-2, Two-Unit Residential
- **General Plan:** RT, Two-Unit Residential

PROJECT SUMMARY

The Applicant requests a tentative parcel map for condominium purposes. Two detached dwelling units will be demolished and replaced with a new two-unit duplex. Approval of the Tentative Parcel Map would allow each unit to be sold individually. No waivers of Title 19 requirements are requested.

RECOMMENDATION

- 1) Conduct a public hearing; and
- 2) Adopt Draft Zoning Administrator Resolution No. _ approving Tentative Parcel Map No. NP2016-025 (Attachment No. ZA 1).

DISCUSSION

- The property is 3,543 square feet in area, and is relatively flat. The property is located north of East Coast Highway, on Narcissus Avenue between Second and Third Avenues.

- Two detached dwelling units will be demolished and replaced by a two-unit duplex. The Code required two-car parking per unit will be provided.
- Approval and recordation of the Tentative Parcel Map will allow each unit to be sold individually.
- The property is designated for two-unit residential use by the General Plan and Zoning Code. The new two-unit dwelling is consistent with this designation and a tentative parcel map for condominiums does not change the use or density on the property.
- The new condominium project will conform to current Newport Beach Municipal Code requirements and meet all Title 19 standards.
- Public improvements will be required of the applicant per the Municipal Code and Subdivision Map Act.

ENVIRONMENTAL REVIEW

The project is categorically exempt under Section 15315, of the State CEQA (California Environmental Quality Act) Guidelines - Class 15 (Minor Land Divisions). The Class 15 exemption allows the division of property in urbanized areas zoned for residential, commercial, or industrial use into four or fewer parcels when the division is in conformance with the General Plan and zoning, no variances or exceptions are required, all services and access to the proposed parcels are available, the parcel was not involved in a division of a larger parcel within the previous two years, and the parcel does not have an average slope greater than 20 percent. The Tentative Parcel Map is for condominium purposes and is consistent with all of the requirements of the Class 15 exemption.

PUBLIC NOTICE

Notice of this application was published in the Daily Pilot, mailed to all owners of property within 300 feet of the boundaries of the site (excluding intervening rights-of-way and waterways), including the applicant, and posted on the subject property at least 10 days before the scheduled hearing, consistent with the provisions of the Municipal Code. Additionally, the item appeared on the agenda for this meeting, which was posted at City Hall and on the City website.

APPEAL PERIOD:

An appeal may be filed with the Director of Community Development within 10 days following the date of action. For additional information on filing an appeal, contact the Planning Division at (949) 644-3200.

Prepared by:

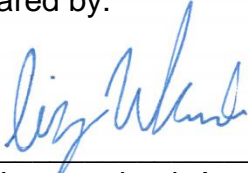

Liz Westmoreland, Assistant Planner

GBR/law

Attachments:	ZA 1	Draft Resolution
	ZA 2	Vicinity Map
	ZA 3	Project Plans

Attachment No. ZA 1

Draft Resolution

RESOLUTION NO. ZA2017-###

A RESOLUTION OF THE ZONING ADMINISTRATOR OF THE CITY OF NEWPORT BEACH APPROVING TENTATIVE PARCEL MAP NO. NP2016-025 FOR TWO-UNIT CONDOMINIUM PURPOSES LOCATED AT 518 and 518 ½ NARCISSUS AVENUE (PA2016-189)

THE ZONING ADMINISTRATOR OF THE CITY OF NEWPORT BEACH HEREBY FINDS AS FOLLOWS:

SECTION 1. STATEMENT OF FACTS.

1. An application was filed by 518 Narcissus Avenue LLC, with respect to property located at 518 and 518 ½ Narcissus Avenue and legally described as the Lot 20 in Block 541 of Corona Del Mar, requesting approval of a tentative parcel map.
2. The applicant proposes a tentative parcel map for two-unit condominium purposes. Two existing detached dwelling units will be demolished and replaced with a new two-unit duplex. The Tentative Parcel Map would allow each unit to be sold individually. No waiver of Title 19 (Subdivisions) development standards are proposed with this application.
3. The subject property is located within the Two-Unit Residential (R-2) Zoning District and the General Plan Land Use Element category is Two-Unit Residential (RT).
4. The subject property is not located within the coastal zone.
5. A public hearing was held on January 12, 2017 in the Corona del Mar Conference Room (Bay E-1st Floor) at 100 Civic Center Drive, Newport Beach. A notice of time, place and purpose of the meeting was given in accordance with the Newport Beach Municipal Code. Evidence, both written and oral, was presented to, and considered by, the Zoning Administrator at this meeting.

SECTION 2. CALIFORNIA ENVIRONMENTAL QUALITY ACT DETERMINATION.

1. This project is exempt from the California Environmental Quality Act (CEQA) pursuant to Section 15315 under Class 15 (Minor Land Divisions) of the CEQA Guidelines, California Code of Regulations, Title 14, Chapter 3.
2. The Class 15 exemption allows the division of property in urbanized areas zoned for residential, commercial, or industrial use into four or fewer parcels when the division is in conformance with the General Plan and zoning, no variances or exceptions are required, all services and access to the proposed parcels are available, the parcel was not involved in a division of a larger parcel within the previous two years, and the parcel does not have an average slope greater than 20 percent. The Tentative Parcel Map is for condominium purposes and is consistent with all of the requirements of the Class 15 exemption.

SECTION 3. REQUIRED FINDINGS.

The Zoning Administrator determined in this case that the Tentative Parcel Map is consistent with the legislative intent of Title 20 (Planning and Zoning) of the Newport Beach Municipal Code and is approved based on the following findings per Section 19.12.070 (Required Findings for Action on Tentative Maps) of Title 19.

Finding:

- A. That the proposed map and the design or improvements of the subdivision are consistent with the General Plan and any applicable specific plan, and with applicable provisions of the Subdivision Map Act and this Subdivision Code.*

Facts in Support of Finding:

1. The Tentative Parcel Map is for two-unit residential condominium purposes. Two detached dwelling units will be demolished and replaced with a new two-unit duplex. The proposed subdivision and improvements are consistent with the density of the R-2 Zoning District and the RT General Plan Land Use Designation.
2. The Tentative Parcel Map is not located within a specific plan area.

Finding:

- B. That the site is physically suitable for the type and density of development.*

Facts in Support of Finding:

1. The lot is physically suitable for a two-unit development because it is regular in shape and is relatively flat.
2. The subject property is accessible from Narcissus Avenue and an alley at the rear, and is adequately served by existing utilities.

Finding:

- C. That the design of the subdivision or the proposed improvements are not likely to cause substantial environmental damage nor substantially and avoidably injure fish or wildlife or their habitat. However, notwithstanding the foregoing, the decision making body may nevertheless approve such a subdivision if an environmental impact report was prepared for the project and a finding was made pursuant to Section 21081 of the California Environmental Quality Act that specific economic, social, or other considerations make infeasible the mitigation measures or project alternatives identified in the environmental impact report.*

Facts in Support of Finding:

1. The site is currently developed with two detached dwelling units, which will be demolished and replaced with a new duplex.
2. The property is located in an urbanized area that does not contain any sensitive vegetation or habitat.
3. The project is categorically exempt under Section 15315 (Article 19 or Chapter 3), of the California Environmental Quality Act (CEQA) Guidelines – Class 15 (Minor Land Divisions).

Finding:

D. That the design of the subdivision or the type of improvements is not likely to cause serious public health problems.

Facts in Support of Finding:

1. The Tentative Parcel Map is for residential condominium purposes. All improvements associated with the project will comply with required Building, Public Works, and Fire Codes, which are in place to prevent serious public health problems. Public improvements will be required of the developer per Section 19.28.010 (General Improvement Requirements) of the Municipal code and Section 66411 (Local agencies to regulate and control design of subdivisions) of the Subdivision Map Act. All ordinances of the City and all Conditions of Approval will be complied with.

Finding:

E. That the design of the subdivision or the type of improvements will not conflict with easements, acquired by the public at large, for access through or use of property within the proposed subdivision. In this connection, the decision making body may approve a map if it finds that alternate easements, for access or for use, will be provided and that these easements will be substantially equivalent to ones previously acquired by the public. This finding shall apply only to easements of record or to easements established by judgment of a court of competent jurisdiction and no authority is hereby granted to the City Council to determine that the public at large has acquired easements for access through or use of property within a subdivision.

Facts in Support of Finding:

1. The design of the development will not conflict with easements acquired by the public at large, for access through, or use of property within the proposed development, because there are no public easements located on the property.

Finding:

F. That, subject to the detailed provisions of Section 66474.4 of the Subdivision Map Act, if the land is subject to a contract entered into pursuant to the California Land Conservation Act of 1965 (Williamson Act), the resulting parcels following a subdivision of the land would not be too small to sustain their agricultural use or the subdivision will result in residential development incidental to the commercial agricultural use of the land.

Facts in Support of Finding:

1. The property is not subject to the Williamson Act because the subject property is not designated as an agricultural preserve and is less than 100 acres in area.
2. The site, developed for residential use, is located within a Zoning District that permits residential uses.

Finding:

G. That, in the case of a "land project" as defined in Section 11000.5 of the California Business and Professions Code: (1) there is an adopted specific plan for the area to be included within the land project; and (2) the decision making body finds that the proposed land project is consistent with the specific plan for the area.

1. California Business and Professions Code Section 11000.5 has been repealed by the Legislature. However, this project site is not considered a "land project" as previously defined in Section 11000.5 of the California Business and Professions Code because the project site does not contain 50 or more parcels of land.
2. The project is not located within a specific plan area.

Finding:

H. That solar access and passive heating and cooling design requirements have been satisfied in accordance with Sections 66473.1 and 66475.3 of the Subdivision Map Act.

Facts in Support of Finding:

1. The Tentative Parcel Map and any future improvements are subject to Title 24 of the California Building Code that requires new construction to meet minimum heating and cooling efficiency standards depending on location and climate. The Newport Beach Building Division enforces Title 24 compliance through the plan check and inspection process.

Finding:

- I. That the subdivision is consistent with Section 66412.3 of the Subdivision Map Act and Section 65584 of the California Government Code regarding the City's share of the regional housing need and that it balances the housing needs of the region against the public service needs of the City's residents and available fiscal and environmental resources.*

Facts in Support of Finding:

1. The proposed two-unit duplex is consistent with the R-2 Zoning District which allows two (2) residential units on the property. Therefore, the Tentative Parcel Map for the proposed condominiums will not affect the City in meeting its regional housing need.

Finding:

- J. That the discharge of waste from the proposed subdivision into the existing sewer system will not result in a violation of existing requirements prescribed by the Regional Water Quality Control Board.*

Facts in Support of Finding:

1. The new two-unit duplex will be designed so that wastewater discharge into the existing sewer system complies with the Regional Water Quality Control Board (RWQCB) requirements.

Finding:

- K. For subdivisions lying partly or wholly within the Coastal Zone, that the subdivision conforms with the certified Local Coastal Program and, where applicable, with public access and recreation policies of chapter three of the Coastal Act.*

Facts in Support of Finding:

1. The subject property is not located within the Coastal Zone.

SECTION 4. DECISION.

NOW, THEREFORE, BE IT RESOLVED:

1. The Zoning Administrator of the City of Newport Beach hereby approves Tentative Parcel Map No. NP2016-025 (PA2016-189), subject to the conditions set forth in Exhibit A, which is attached hereto and incorporated by reference.
2. This action shall become final and effective 10 days after the adoption of this Resolution unless within such time an appeal or call for review is filed with the Director

of Community Development in accordance with the provisions of Title 19 Subdivisions, of the Newport Beach Municipal Code.

PASSED, APPROVED, AND ADOPTED THIS 12th DAY OF JANUARY, 2017.

Patrick J. Alford, Zoning Administrator

DRAFT

EXHIBIT "A"**CONDITIONS OF APPROVAL**

1. The project is subject to all applicable City ordinances, policies, and standards, unless specifically waived or modified by the conditions of approval.
2. Subsequent to the recordation of the Parcel Map, the applicant shall apply for a building permit for a description change of the subject project development from "duplex" to "condominium." **The development will not be condominiums until this permit is finalized.** The building permit for the new construction shall not be finalized until after recordation of the Parcel Map.
3. This approval shall expire and become void unless exercised within 24 months from the actual date of review authority approval, except where an extension of time is approved in compliance with the provisions of Title 20 Planning and Zoning of the Newport Beach Municipal Code.
4. A parcel map shall be recorded. The Map shall be prepared on the California coordinate system (NAD88). Prior to recordation of the Map, the surveyor/engineer preparing the Map shall submit to the County Surveyor and the City of Newport Beach a digital-graphic file of said map in a manner described in Section 7-9-330 and 7-9-337 of the Orange County Subdivision Code and Orange County Subdivision Manual, Subarticle 18. **The Map to be submitted to the City of Newport Beach shall comply with the City's CADD Standards. Scanned images will not be accepted.**
5. Prior to recordation of the parcel map, the surveyor/engineer preparing the map shall tie the boundary of the map into the Horizontal Control System established by the County Surveyor in a manner described in Sections 7-9-330 and 7-9-337 of the Orange County Subdivision Code and Orange County Subdivision Manual, Subarticle 18. Monuments (one inch iron pipe with tag) shall be set On Each Lot Corner unless otherwise approved by the Subdivision Engineer. Monuments shall be protected in place if installed prior to completion of construction project.
6. All improvements shall be constructed as required by Ordinance and the Public Works Department.
7. Reconstruct the existing broken and/or otherwise damaged concrete sidewalk panels, curb and gutter along the Narcissus Avenue frontage.
8. All existing overhead utilities servicing the project property shall be undergrounded.
9. All existing drainage facilities in the public right-of-way, including the existing non-standard curb drain along Narcissus Avenue frontage shall be retrofitted to comply with the City's on-site non-storm runoff retention requirements.
10. No above ground improvements shall be installed within the 5-foot alley setback.

11. All existing private, non-standard improvements within the public right-of-way and/or extensions of private, non-standard improvements into the public right-of-way fronting the development site shall be removed.
12. Each unit shall be served by its individual water meter and sewer lateral and cleanout. Each water meter and sewer cleanout shall be installed with a traffic-grade box and cover. Water meter and the sewer cleanout shall be located within the public right-of-way.
13. An encroachment permit is required for all work activities within the public right-of-way.
14. All improvements shall comply with the City's sight distance requirement. See City Standard 110-L and Municipal Code Section 20.30.130.
15. In case of damage done to public improvements surrounding the development site by the private construction, additional reconstruction within the public right-of-way could be required at the discretion of the Public Works Inspector.
16. All on-site drainage shall comply with the latest City Water Quality requirements.
17. All unused water services to be abandoned shall be capped at the main (corporation stop) and all unused sewer laterals to be abandoned shall be capped at property line. If the sewer lateral to be abandoned has an existing cleanout, abandonment shall include removal of the cleanout riser, the 4TT box and the wye. Sewer lateral shall then be capped where the wye used to be.
18. Per Chapter 13 of the City Municipal Code, one (1) 36-inch box street tree shall be planted along the Narcissus Avenue frontage. Tree species shall be per Council Policy G-6 (Attachment 2).
19. Reconstruct driveway within rear yard setback to be drivable from one property to another. No steps or raised driveways will be permitted.
20. Reconstruct existing damaged alley concrete panels. Extent of repair to be determined by Public Works inspector.
21. Single or multiple-station smoke alarms shall be installed and maintained in the following locations: On the ceiling or wall outside of each separate sleeping area in the immediate vicinity of bedrooms, in each room used for sleeping purposes, in each story within a dwelling unit. C.F.C. Sec. 907.2.11.2.
22. C.F.C. Sec. 903.2.8. An automatic sprinkler system installed in accordance with Section 903.3 shall be provided throughout all buildings with a Group R fire area. Plans will need to be submitted and approved prior to construction. The units will require separate utilities for the fire sprinklers.

-
23. Carbon monoxide alarms are required in new construction in group R occupancies. Carbon monoxide alarms shall receive their primary power from the building wiring where such wiring is served from a commercial source and shall be equipped with a battery back-up. Alarm wiring shall be directly connected to the permanent building wiring without a disconnecting switch other than as required for overcurrent protection. Where more than one carbon monoxide alarm is required to be installed within the dwelling unit or within a sleeping unit, the alarm shall be interconnected in a manner that activation of one alarm shall activate all of the alarms in the individual unit. CBC. Sec. 420.
24. To the fullest extent permitted by law, applicant shall indemnify, defend and hold harmless City, its City Council, its boards and commissions, officials, officers, employees, and agents from and against any and all claims, demands, obligations, damages, actions, causes of action, suits, losses, judgments, fines, penalties, liabilities, costs and expenses (including without limitation, attorney's fees, disbursements and court costs) of every kind and nature whatsoever which may arise from or in any manner relate (directly or indirectly) to City's approval of the 518 Narcissus Avenue Condominiums including, but not limited to, Tentative Parcel Map No. NP2016-025 (PA2016-189). This indemnification shall include, but not be limited to, damages awarded against the City, if any, costs of suit, attorneys' fees, and other expenses incurred in connection with such claim, action, causes of action, suit or proceeding whether incurred by applicant, City, and/or the parties initiating or bringing such proceeding. The applicant shall indemnify the City for all of City's costs, attorneys' fees, and damages which City incurs in enforcing the indemnification provisions set forth in this condition. The applicant shall pay to the City upon demand any amount owed to the City pursuant to the indemnification requirements prescribed in this condition.

Attachment No. ZA 2

Vicinity Map

VICINITY MAP



Tentative Parcel Map No. NP2016-025
PA2016-189

518 and 518 ½ Narcissus Avenue

Attachment No. ZA 3

Project Plans

NARCISSUS AVENUE**TENTATIVE PARCEL
MAP NO. 2016-188**

OCTOBER 2016

SITE ADDRESS

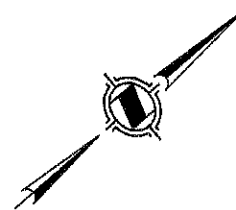
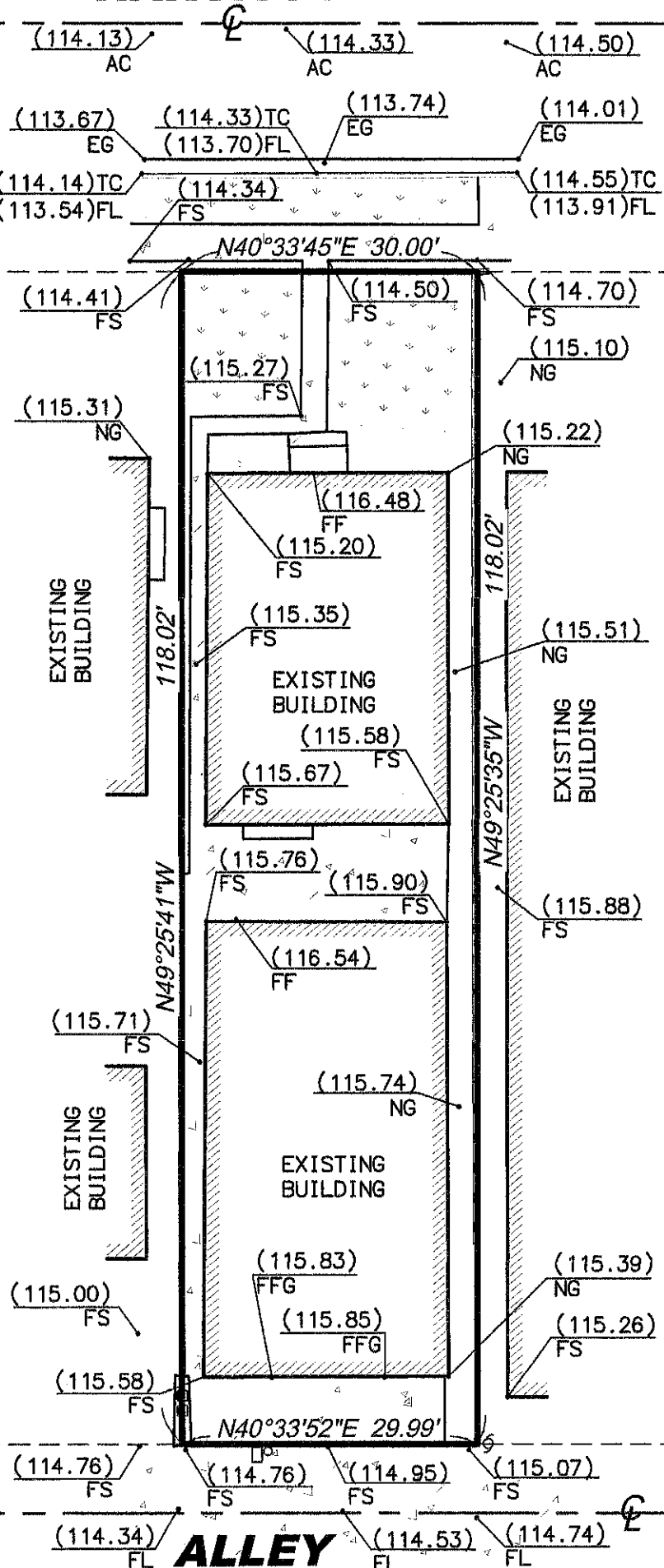
518 NARCISSUS AVENUE
NEWPORT BEACH, CA 92625
(APN: 459-213-08)LOTS 20, BLOCK 541
CORONA DEL MAR TRACT
M.M. 3/41-42THE LAND REFERRED TO HEREIN BELOW IS
SITUATED IN THE COUNTY OF ORANGE, STATE
OF CALIFORNIA, AND DESCRIBED AS FOLLOWS:LOT 20 OF BLOCK 541 OF CORONA DEL MAR IN
THE CITY OF NEWPORT BEACH, COUNTY OF
ORANGE, STATE OF CALIFORNIA, AS PER MAP
RECORDED IN BOOK 3, PAGES 41 AND 42 OF
MISCELLANEOUS MAPS, IN THE OFFICE OF THE
COUNTY RECORDER OF SAID ORANGE COUNTY.OWNER/DEVELOPER:518 NARCISSUS, LLC, A CALIFORNIA LIMITED
LIABILITY COMPANY

SCALE = 1" = 16'

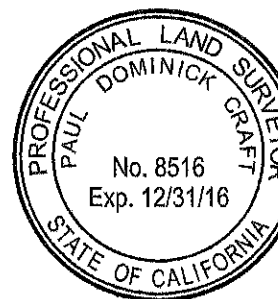

PREPARED BY:

10/25/2016

PAUL D. CRAFT, P.L.S. 8516
LICENSE EXPIRES 12/31/16**APEX LAND SURVEYING
INC.**HUNTINGTON BEACH, CALIFORNIA 92646
PHONE: (714) 488-5006 FAX: (714) 333-4440
APEXLSINC@GMAIL.COMPA2016-189 for NP2016-025
518 and 518 1/2 Narcissus Avenue
518 Narcissus LLC