



CITY OF NEWPORT BEACH

Public Works Department

Municipal Operations Division

Tree Removal or Reforestation Application

Per City Council Policy G-1 (Retention, Removal, and Maintenance of City Trees), I am **requesting** a tree removal(s) to be reviewed by staff and submitted to either the Parks, Beaches, and Recreation Commission for consideration at a future meeting or the appropriate City approving authority. I am aware that Commission meetings are regularly held on the first Tuesday of each month (except for holidays) at 6:00 p.m. in the Council Chambers.

1 LARGE EUCALYPTUS TREE

Quantity and species, if known, of tree(s).

ALTA VISTA & CHESTNUT PL

Location of tree(s)

Please be as specific as possible

Requestor

- Property Owner
- Community Association
- Other _____

Address/ Phone (Daytime) / Email

901 CHESTNUT PL NEWPORT
 BEACH CA 92660
 EMAIL GEOFF@DARBY.CC
 MOBILE 650 326 7200
 Date: 2-18-2026

Signature: _____

Print Name: GEOFFREY DARBY

REFORESTATION REQUESTS: Please proceed to Section B.

Section A. For Tree Removal Requests Only

Removal Criteria (Check one or more)

Please provide copies of photos, bills, documents or any other related material that will verify the checked items.

- Proven and repeated history of **damaging** public or *private, sewers, water mains, roadways, sidewalks, curbs, walls, fences, underground utilities or foundations. (*Greater than \$500)
- Repeated history of **significant interference** with street or sidewalk drainage.
- Dying** Has no prospect of recovery.
- Diseased** Cannot be cured by current arboricultural methods. In advanced state of decline with no prospect of recovery.
- Hazardous** Defective, potential to fail, could cause damage to persons/property upon failure. Assessment by City Arborist will identify structural defects, parts likely to fail, targets-if fails, procedures and actions to abate.
- Beautification Project** In conjunction with a City Council-approved City, commercial, neighborhood, or community association beautification program.

Section B. For Reforestation Requests Only

Reforestation is the concept of systematically replacing Problem or All Other Trees which are creating hardscape and/or view problems and cannot be properly trimmed, pruned or modified to alleviate the problem(s) they create, or those which have reached their full life, and are declining in health, or are simply the wrong species of tree(s) for the planted location.

As initiated by:

- Property Owner
- Community Association
- Other _____

Check all items applicable:

- Tree(s) causing curb, gutter, sidewalk or underground utilities damage.
- Wrong tree species for location
- View encroachment
- Area has clearly defined contiguous boundaries that include the tree(s) proposed.
- Residential communities, neighborhoods, or business organizations who apply for reforestation must submit a petition signed by a minimum of 60% of the property owners within the area defined.
- Areas represented by a legally established community association, may submit a resolution of the Board of Directors formally requesting a reforestation.
- Individual property owners must submit a petition signed by a minimum of 60% of a maximum of 30 private property owners (up to 15 contiguous private properties on both sides of the street up to 500' in either direction from the location of the proposed reforestation site) as well as the endorsement of the appropriate homeowners' association, if applicable.

*A request for reforestation requires a written agreement submitted to the Parks, Beaches, and Recreation Commission by the petitioning sponsor (Individual private property owner(s) or group) to pay 100% of the costs of the removal and replacement of the public tree(s) in advance of any removal activity. The actual removal and replanting will be coordinated by the Public Works Department/Municipal Operations Division using the City tree maintenance contractor.

*There shall be a minimum of a one-for-one replacement of all tree(s) removed in reforestation projects. Replacement tree(s) shall be a minimum size of 36" boxed tree and cost ranges from \$706 to \$910, unless the parkway space will not accommodate a 36" boxed tree or a tree cannot be planted due to planting restrictions contained in City Council Policy G-6.

This form does not replace the requirements of any of the City tree policies. Its use is intended to expedite the tree removal or reforestation requests and to ensure compliance with all City requirements. Please refer to individual City Council Policy G-1 for additional information.

REQUESTOR COMMENTS: SEE ATTACHED EMAIL

Removals, except emergency, will be subject to the notification processes, time frames and authority as specified in the City Council G-1 Policy.



CITY OF NEWPORT BEACH

Public Works Department

Municipal Operations Division

Tree Removal or Reforestation Application

Per City Council Policy G-1 (Retention, Removal, and Maintenance of City Trees), I am requesting a tree removal(s) to be reviewed by staff and submitted to either the Parks, Beaches, and Recreation Commission for consideration at a future meeting or the appropriate City approving authority. I am aware that Commission meetings are regularly held on the first Tuesday of each month (except for holidays) at 6:00 p.m. in the Council Chambers.

EUCALYPTUS

Quantity and species, if known, of tree(s).

ALTA VISTA - CHESTNUT PL, NEWPORT BEACH

Location of tree(s)

Please be as specific as possible

Requestor

Property Owner
 Community Association
 Other

Address/ Phone (Daytime) / Email

901 CHESTNUT PL
 NEWPORT BEACH
 CA 92660

Signature:

[Handwritten Signature]

Date:

4/15/2026

Print Name:

GEOFF REY DARBY

REFORESTATION REQUESTS: Please proceed to Section B.

Section A. For Tree Removal Requests Only

Removal Criteria (Check one or more)

Please provide copies of photos, bills, documents or any other related material that will verify the checked items.

- Proven and repeated history of **damaging** public or *private, sewers, water mains, roadways, sidewalks, curbs, walls, fences, underground utilities or foundations. (*Greater than \$500)
- Repeated history of **significant interference** with street or sidewalk drainage.
- Dying** Has no prospect of recovery.
- Diseased** Cannot be cured by current arboricultural methods. In advanced state of decline with no prospect of recovery.
- Hazardous** Defective, potential to fail, could cause damage to persons/property upon failure. Assessment by City Arborist will identify structural defects, parts likely to fail, targets-if fails, procedures and actions to abate.
- Beautification Project** In conjunction with a City Council-approved City, commercial, neighborhood, or community association beautification program.

Section B. For Reforestation Requests Only

Reforestation is the concept of systematically replacing Problem or All Other Trees which are creating hardscape and/or view problems and cannot be properly trimmed, pruned or modified to alleviate the problem(s) they create, or those which have reached their full life, and are declining in health, or are simply the wrong species of tree(s) for the planted location.

As initiated by:

- Property Owner
- Community Association
- Other _____

Check all items applicable:

- Tree(s) causing curb, gutter, sidewalk or underground utilities damage.
- Wrong tree species for location
- View encroachment
- Area has clearly defined contiguous boundaries that include the tree(s) proposed.
- Residential communities, neighborhoods, or business organizations who apply for reforestation must submit a petition signed by a minimum of 60% of the property owners within the area defined.
- Areas represented by a legally established community association, may submit a resolution of the Board of Directors formally requesting a reforestation.
- Individual property owners must submit a petition signed by a minimum of 60% of a maximum of 30 private property owners (up to 15 contiguous private properties on both sides of the street up to 500' in either direction from the location of the proposed reforestation site) as well as the endorsement of the appropriate homeowners' association, if applicable.

*A request for reforestation requires a written agreement submitted to the Parks, Beaches, and Recreation Commission by the petitioning sponsor (Individual private property owner(s) or group) to pay 100% of the costs of the removal and replacement of the public tree(s) in advance of any removal activity. The actual removal and replanting will be coordinated by the Public Works Department/Municipal Operations Division using the City tree maintenance contractor.

*There shall be a minimum of a one-for-one replacement of all tree(s) removed in reforestation projects. Replacement tree(s) shall be a minimum size of 36" boxed tree and cost ranges from \$706 to \$910, unless the parkway space will not accommodate a 36" boxed tree or a tree cannot be planted due to planting restrictions contained in City Council Policy G-6.

This form does not replace the requirements of any of the City tree policies. Its use is intended to expedite the tree removal or reforestation requests and to ensure compliance with all City requirements. Please refer to individual City Council Policy G-1 for additional information.

REQUESTOR COMMENTS:

Removals, except emergency, will be subject to the notification processes, time frames and authority as specified in the City Council G-1 Policy.

Subject. Eucalyptus tree on the corner of Alta Vista and Chestnut Pl.

Dear Mr. Nelson,

In the past two years since we purchased 901 Chestnut Dr, we have been updating and refurbishing our house inside and out. It has been brought to our attention that the Eucalyptus tree in front of our house on Alta Vista has had its root system significantly cut not just pruned. These trees are known for their shallow root structure and for a tree of this size and age the work done to the tree in previous years has introduced a high level of probability that the tree could uproot in a severe storm. We remember very clearly the death of the woman who died in 2011 when a much smaller eucalyptus tree fell on top of her car down on Irvine Avenue.

We were very worried about the damage the tree could cause if it uprooted so we contacted our insurance company Privilege Underwriters Reciprocal Exchange (PURE) out of New York. Their Loss Prevention Group assigned a local Arborist from Legacy Landscape Company, Louis Hernandez, to appraise the tree which he did on February 6th, 2026.

I met with Mr Hernandez when he came out to inspect the tree and I was not aware that on the side facing the road there are very visible signs that there has been significant cutting and clearing out of the main roots and there are holes right at the foot of the tree. If you look carefully at the road and concrete curb it looks as though some years ago, work was done to repair damage caused by the tree's roots. On the opposite side of the tree next to the walkway, there are also signs of significant cutting out of the roots. We have learned from our neighbors that the builder and previous owner of our property Dan Heinsfeld, who is a master architect, most likely would have installed a root barrier under the property wall which is hidden by the tall green hedge. We understand that Mr. Heinfeld was very concerned and had approached the City about the trees safety and had asked to have the tree removed.

Given the severity of the storms we have been having this week I am very worried that the tree could topple over. Mr. Hernandez's Company does major tree work and he thinks that the tree could weigh over 25 tons and if it uprooted nothing in its path would survive. I spoke to our neighbors across Alta Vista and Mrs. Goethals said she was worried all last night about THAT tree. If the tree is supported only by roots running along the easement and it collapses it would choose one of the two paths of least resistance which would be to come down on us or Mrs. Goethals. Take a look at what happened this past Tuesday.

["https://www.nbclosangeles.com/video/news/local/large-trees-comes-crashing-down-in-costa-mesa-after-rain/3848734/"](https://www.nbclosangeles.com/video/news/local/large-trees-comes-crashing-down-in-costa-mesa-after-rain/3848734/)

Mr. Hernandez is submitting his report to Pure this week, which is a Level 1 visual review of the tree's condition and I agree with his recommendation to get a Master arborist involved to do a level 2 or 3 review which would involve drilling around the tree to understand the condition of the root structure OR just take the tree down immediately.

Geoff Darby, 901 Chestnut Pl, Newport Beach, CA 92660, Email:geoff@darby.cc, Cell 650-326-7200.

Subject. Eucalyptus tree on the corner of Alta Vista and Chestnut Pl. February 20th, 2026

Dear Mr. Nelson,

In the past two years since we purchased 901 Chestnut Dr, we have been updating and refurbishing our house inside and out. It has been brought to our attention that the Eucalyptus tree in front of our house on Alta Vista has had its root system significantly cut not just pruned. These trees are known for their shallow root structure and for a tree of this size and age the work done to the tree in previous years has introduced a high level of probability that the tree could uproot in a severe storm. We remember very clearly the death of the woman who died in 2011 when a much smaller eucalyptus tree fell on top of her car down on Irvine Avenue.

We were very worried about the damage the tree could cause if it uprooted so we contacted our insurance company Privilege Underwriters Reciprocal Exchange (PURE) out of New York. Their Loss Prevention Group assigned a local Arborist from Legacy Landscape Company, Louis Hernandez, to appraise the tree which he did on February 6th, 2026.

I met with Mr Hernandez when he came out to inspect the tree and I was not aware that on the side facing the road there are very visible signs that there has been significant cutting and clearing out of the main roots and there are holes right at the foot of the tree. If you look carefully at the road and concrete curb it looks as though some years ago, work was done to repair damage caused by the tree's roots. On the opposite side of the tree next to the walkway, there are also signs of significant cutting out of the roots. We have learned from our neighbors that the builder and previous owner of our property Dan Heinfeld, who is a master architect, most likely would have installed a root barrier under the property wall which is hidden by the tall green hedge. We understand that Mr. Heinfeld was very concerned and had approached the City about the trees safety and had asked to have the tree removed.

Given the severity of the storms we have been having this week I am very worried that the tree could topple over. Mr. Hernandez's Company does major tree work and he thinks that the tree could weigh over 25 tons and if it uprooted nothing in its path would survive. I spoke to our neighbors across Alta Vista and Mrs. Goethals said she was worried all last night about THAT tree. If the tree is supported only by roots running along the easement and it collapses it would choose one of the two paths of least resistance which would be to come down on us or Mrs. Goethals. Take a look at what happened this past Tuesday.

["https://www.nbclosangeles.com/video/news/local/large-trees-comes-crashing-down-in-costa-mesa-after-rain/3848734/"](https://www.nbclosangeles.com/video/news/local/large-trees-comes-crashing-down-in-costa-mesa-after-rain/3848734/)

Mr. Hernandez is submitting his report to Pure this week, which is a Level 1 visual review of the tree's condition and I agree with his recommendation to get a Master arborist involved to do a level 2 or 3 review which would involve drilling around the tree to understand the condition of the root structure OR just take the tree down immediately.

Geoff Darby, 901 Chestnut Pl, Newport Beach, CA 92660, Email:geoff@darby.cc, Cell 650-326-7200.

Eastbluff Homeowners Community Association

c/o: Tritz Professional Management Services, Inc.

1525 East 17th Street, Suite A

Santa Ana ♦ California ♦ 92705

(714) 557-5900 Phone ♦ (714) 442-2543Fax

March 4, 2026

City of Newport Beach
John J. Nelson
100 Civic Center Drive
Newport Beach, CA 92660

Via Email and Regular US Mail

jjnelson@newportbeachca.gov

**Re: Eastbluff Homeowners Community Association
901 Chestnut Place, Newport Beach, CA 92660
Association Approval for Tree Removal and Reforestation**

Dear Mr. Nelson:

It is the understanding of the Association that Geoffrey C. and Carol G. Darby of 901 Chestnut Place, Newport Beach, CA 92660, have made application for Removal and Reforestation of a parkway tree located adjacent to the 901 Chestnut Property.

At their March 2, 2026 meeting, the Board of Directors of the Eastbluff Homeowners Community Association approved their support of the homeowners' request to have the City of Newport Beach work with Mr. and Mrs. Darby to remove and replace the tree under the City's Reforestation guidelines.

If you have any questions, please contact our office for assistance.

Sincerely,
On Behalf of the Board of Directors
Eastbluff Homeowners Community Association

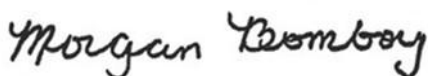

Morgan Bomboy, CCAM
General Manager, Tritz Professional Management Services

Cc: Mr. and Mrs. Darby



Municipal Operations Department

May 14, 2026

TO: Landscape Manager

FROM: City Arborist

SUBJECT: *Tree Removal Review*

PROPERTY OWNER(S) / REQUESTER INFORMATION:

Name: Geoffrey Darby

Tree Location: 901 Chestnut Place / Side 1

The applicant, Geoffrey Darby (residing at 901 Chestnut Place), contacted the City to request the removal of a Manna Gum Eucalyptus (*Eucalyptus viminalis*) located on the Alta Vista side of his home due to previous root damage, unbalanced canopy, limited scaffolding root structure on the street side and perceived elevated risk of a whole tree failure.

A Level 3 field inspection conducted by the applicant's consulting arborist reported that several surface roots had previously been cut, and the ground penetrating radar demonstrated the absence of structural roots on the street side of the tree. City staff confirmed both sidewalk (65 sq.ft.) and curb & gutter (21 linear feet) adjacent to the tree had been repaired in 2010. Additionally, the applicant's consulting arborist noted an unbalanced canopy, which was weighted away from the applicant's home. City staff noted this was due to repeated clearance pruning on the side of the canopy facing the home.

The applicant's consulting arborist rated the tree's condition at the time of inspection (March 31, 2026) as 'High', with the tree part of concern being the identified previous root pruning. For this reason, they recommended the tree's removal. Additionally, the applicant's consulting arborist offered alternative mitigation in the form of a crown reduction (via drop crotching) of the overall height by 25%.

On April 23, 2026, at the direction of City staff, the City's tree-trimming contractor performed the prescribed crown reduction via drop-crotching, reducing the canopy by approximately 25%. Additionally, City staff directed the City's on-call consulting arborist to perform a peer review of Mr. Darby's arborist's report, and their own Level 2 Tree Risk Assessment after mitigation measures had taken place. On April 28, 2026, the City's on-call consulting arborist performed an inspection to determine if the mitigation measures would lower the overall risk rating.

On May 13, 2026, staff received their consultant's report, which placed the overall risk rating at 'Moderate', but recommended removal within the next 12 months because of the possible likelihood of failure during *extreme weather events*. This is a higher standard



Municipal Operations Department

TREE INSPECTION REPORT

Name: Geoffrey Darby

Location(s) of tree(s): 901 Chestnut Place / Side 1

Request: The applicant, Geoffrey Darby, residing at 901 Chestnut Place, contacted the City to request the removal of a Manna Gum Eucalyptus (*Eucalyptus viminalis*) located on the side of his home on Alta Vista due to previous root damage, unbalanced canopy, limited scaffolding root structure on the street side and perceived elevated risk of a whole tree failure.

Botanical/Common Names: Manna Gum Eucalyptus (*Eucalyptus viminalis*)

Estimated Tree Value: \$17,220.00

Replacement Street Tree: Jacaranda (*Jacaranda mimosifolia*) x 2 – 48-inch boxes

Damage: N/A

Parkway: Concrete Brick Turf (X) Other

Comments: The applicant, Geoffrey Darby, residing at 901 Chestnut Place, contacted the City to request the removal of a Manna Gum Eucalyptus (*Eucalyptus viminalis*) located on the Alta Vista side of his home.

Mr. Darby attained a certified arborist to perform a Level 3 risk assessment using ground penetrating radar. The assessment came back with High risk and recommended the tree's removal. Staff had a City consultant perform a peer review and their own assessment. The consultant's assessment was of a moderate risk but recommended eventual removal. Based on these findings, the Manna Gum meets the criteria for removal referenced in the City Council Policy G-1.

The City will pay for the removal of the Manna Gum, while Mr. Darby has offered to pay for the replacement of the tree with two 48-inch box Jacaranda trees (*Jacaranda mimosifolia*).

Inspected by: 
John J. Nelson, City Arborist

Date: May 14, 2026

Recommendation: Staff approves the request for removal of the Manna Gum Eucalyptus

Reviewed by:



Kevin Pekar, Landscape Manager

Date: May 14, 2026



Public Works

CA 64689























Detail Notes Images Documents Observations

Inventory Detail

Tree ID	972864	Old Tag #	<input type="text"/>	Save
District	1			
Area	1			
Address	901 CHESTNUT PL			
Side/Site	Side - 1			
Alt Address	2720 ALTA VISTA DR			
Tree Species	<u>Eucalyptus viminalis</u> / Eucalyptus - Viminalis			
Common Name	Manna Gum			
Size	31+			
Height	60+			
DBH				
Condition	FAIR			
Pruning Frequency				
Grow Space				
Space Size				
Overhead Utility				
Sidewalk Damage				
Note:				
Irrigation Flag	Yes	No		
Monitor Flag	Yes	No		
Service Type	Grid Pruning			
Season	AUG/OCT			
Estimated Value	\$17,220.00			
Next Date				



Latitude: 33.640440862 Longitude: -117.870399208 ([edit](#))

Service History							New
Scope	WO Ref #	Description	Who	Service Date	Invoice Date	Service	Price
Invoiced	58108	2025 - Eucalyptus Trimming (Grids 1, 8, 12, 16, 18) Oct Progress	GSTS	10/22/25	10/30/25	Grid Pruning	69.07
Invoiced	52449	2024 - (N) Supplemental Trimming at 901 CHESTNUT PL	GSTS	3/22/24	3/22/24	Homeowner Request	0.00
Invoiced	52449	2024 - (N) Supplemental Trimming at 901 CHESTNUT PL	GSTS	3/22/24	3/22/24	Crew Rental	74.29
Invoiced	49068	2023 - Grid 1 Eastbluff (Broadleaves) - (Mar Progress)	GSTS	3/23/23	3/24/23	Grid Pruning	57.99
Invoiced	42751	2020 - GRID 1 (Eastbluff) - Broadleaves (Jan. Progress)	GSTS	1/25/21	1/28/21	Grid Pruning	55.20
Invoiced	36064	2019 - GRID 1 (Broadleaves) - Feb. Progress	GSTS	2/07/19	2/26/19	Grid Pruning	52.53
Invoiced	34620	2018 - INCLEMENT WEATHER 10/17/18	GSTS	10/17/18	10/17/18	Debris Removal	0.00
Invoiced	27833	2017 - Grid 1 (Eastbluff) - Broadleafs	GSTS	1/26/17	1/31/17	Grid Pruning	50.13
Invoiced	24439	2016 - WR37912 - Service Request	GSTS	4/05/16	4/05/16	Service Request	59.72
Invoiced	17698	2014 - Grid 1 - Eastbluff (Revised)	GSTS	2/21/14	3/07/14	Grid Pruning	48.00
Work History			WCA	5/03/11		Other	0.00
Work History			WCA	6/30/10		Other	0.00
Work History			WCA	8/05/09		Other	0.00
Work History			WCA	7/29/08		Other	0.00
Work History			WCA	4/26/07		Other	0.00
Work History			WCA	3/03/04		Other	0.00
Work History			WCA	7/18/03		Other	0.00
Work History			WCA	12/15/00		Other	0.00

Arborist Report
Louis M. Hernandez Jr.
ISA Certified Arborist # WE-13022A

March 31, 2026

SITE INFORMATION:

Mr. Geoffrey Darby
901 Chestnut Pl.
Newport Beach, CA 92660

BACKGROUND AND ASSIGNMENT:

I was contacted to inspect a *Eucalyptus viminalis* growing in the city parkway adjacent to residence's property. The homeowner was concerned about the tree's size and relative location to his home. He had become aware that trees of this type had recently been involved in failures that caused severe property damage and even one death to a motorist. I was initially hired to perform a Level I inspection and a report.

The City of Newport Beach then asked Mr. Darby to hire an arborist to perform a risk assessment of the tree based on a level III Advanced Inspection. They recommended he either perform air spading or ground penetrating radar root mapping. Mr. Darby asked me to provide that requested report and Ground Penetrating Radar mapping.

GENERAL SITE OBSERVATIONS:

The subject tree is approximately 80 ft. tall and appears to be well maintained. The tree is growing approximately 60 lf. from the dwelling. The area of the dwelling closest to the subject tree is the residence's living quarters, the den, bedroom and kitchen. The subject tree is growing in a parkway area that is covered in synthetic turf except where the tree exists. There appears to be no irrigation system for the subject tree. The tree has a DBH of 4'. The tree has a normal root flair except for large surface roots that have been cut within 2' of the edge of the trunk base. (see Attachment A – Photo 1) There is no mulch covering over the root flair. The cut roots appear, upon visual inspection to be properly healed. There is a large void on the street side of the root flair, but no visible injury that could have caused the void. (see Attachment A – Photo 2) It appears that a portion of the city curb and gutter directly adjacent to the tree has been replaced. The new joint between the old and new curb and gutter has begun to be lifted. The tree's crown has been trimmed away from the residence and is visibly off balance towards the street side. (see Attachment – Photo 3)

The Canopy has some dead wood in its upper reaches and one of the main structural branches has a wound that is weeping. To create the crown into its unbalanced existence, the tree has evidence of topping. There appears to be included bark on the lower branch crotches. (See Attachment A - Photo 4)

LEVEL III TREE RISK ASSESSMENT:

Since the most concerning issue with this tree is the appearance of many large cut roots within two feet of the tree trunk, I decided to hire a Ground Penetrating Radar Technician to perform root mapping. Linear scans were performed on the root mass of the subject tree on the street side with four different scans taken. The results of the GPR Root Mapping are included in this report. (see Attachment B - Figures 1-7)

A Tree Risk Assessment Matrix of the subject tree was completed, with the target being the retired people living in the part of the residence closest to the subject tree, and because of the root mass damage and recovery of the subject tree on the opposite side of the subject tree from the residence, it was determined that the Risk Rating of this tree was HIGH. (see Attachment C - Matrix of Tree Risk Assessment)

CONCLUSIONS:

The results of the GPR show that few to no larger roots exist on the street side of the tree. Many small to medium roots exist as reaction growth as a result of the cutting and removal of the larger roots. The regrowth of roots and the existence of the large void in the root flare are supporting the health of the tree, but they may not be contributing adequately to the structural integrity and stability of the tree

The subject tree is relatively healthy and growing, however because of the absence of structural roots on the street side of the subject tree, the potential for catastrophic failure with potential harm to human life, living in the adjacent residence, and because this tree has little to no intrinsic value for the community where it exists, it is my opinion that this tree should be removed.

RECOMENDATIONS:

Tree removal at the earliest possible opportunity, to mitigate potential harm to humans.

If the tree is not removed, then reducing the height of the tree by removing at least 25% of its height, is highly recommended. Please note that this kind of severe trimming could potentially weaken or could also cause the decline of the subject tree. Therefore, if crown reduction is the ultimate remedy preferred by the owner of this tree, The City of Newport Beach, then 'drop crotching' of the tree is recommended as a means to lower the tree's height. This tree should then have yearly inspections by a Certified Arborist to assess the health of the tree.

ARBORIST'S DISCLAIMER: Arborists are tree specialists who use their education, knowledge, training and experience to examine trees, recommend measures to enhance the beauty and health of trees, and attempt to reduce the risk of living near trees. Clients may choose to accept or disregard the recommendations of the arborist, or to seek additional advice. Arborists cannot detect every condition that could possibly lead to structural failure of a tree or anticipate extreme weather events that could contribute to failure. Trees are living organisms that fail in ways we do not fully understand. Conditions are often hidden within trees and below ground. Arborists cannot guarantee that a tree will be healthy or safe under all circumstances, or for a specified period of time. Likewise, remedial treatments, like any medicine, cannot be guaranteed. Treatment, pruning and removal of trees may involve considerations beyond the scope of the Arborists services such as property boundaries, property ownership, site lines, disputes between neighbors, and other issues. Arborists cannot take such considerations into account unless complete and accurate information is disclosed to the arborist. An arborist should then be expected to reasonably rely upon the completeness and accuracy of the information provided.

Please contact me if you have any questions. Cell Phone: 714-720-3804

Sincerely,

Louis M. Hernandez Jr.
ISA Certified Arborist WE-13022A
Tree Risk Assessment Qualified

ATTACHMENT A – PHOTOS



PHOTO #1 – ARROWS INDICATE CUT ROOTS

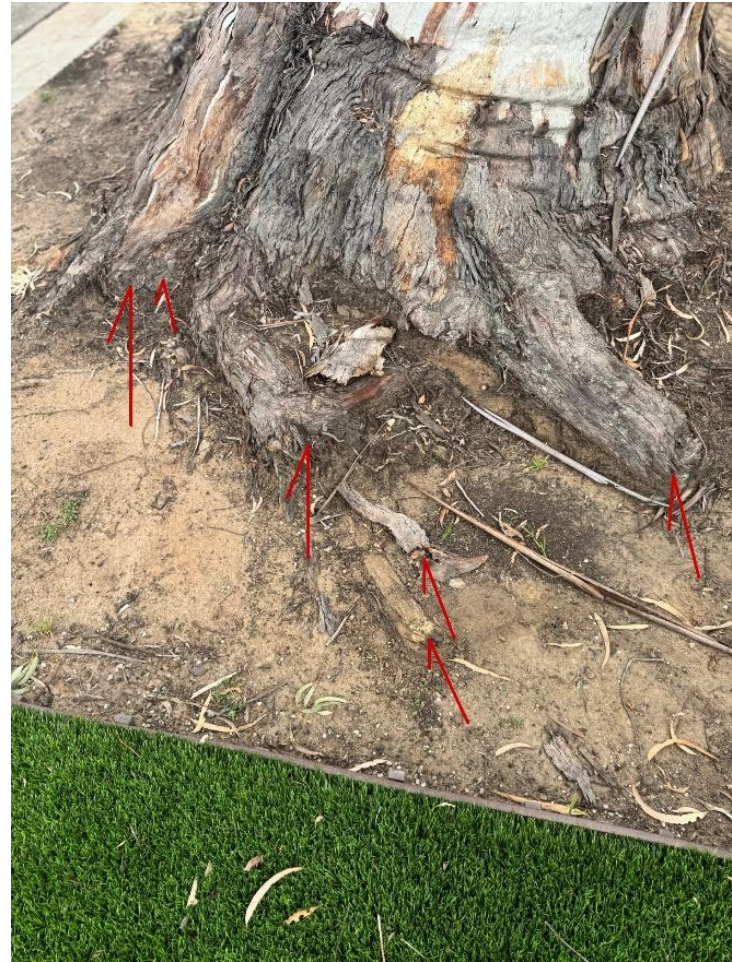

PHOTO #2 AAROWS INDICATE CUT ROOTS

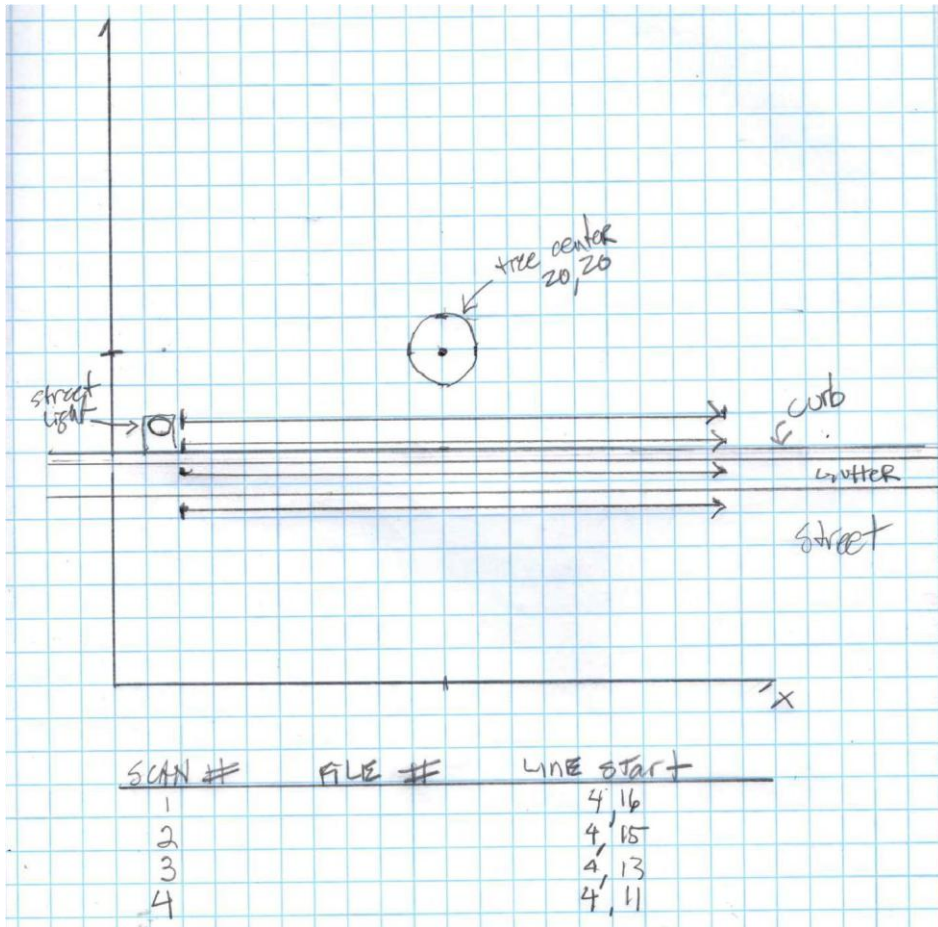

PHOTO #3 – UNBALANCED TREE CANOPY



PHOTO #4 – INCLUDED BARK ON LOWER CROTCH

ATTACHMENT B



Site sketch of project area

Based on X, Y coordinates

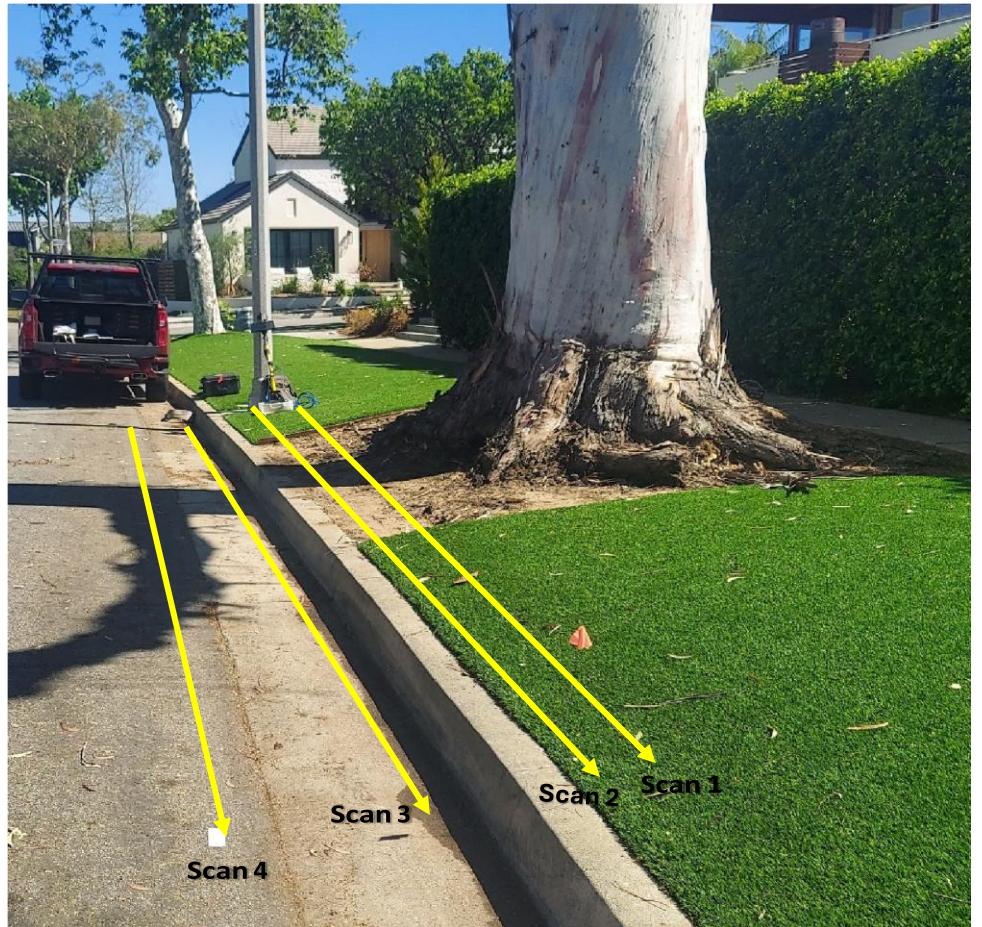

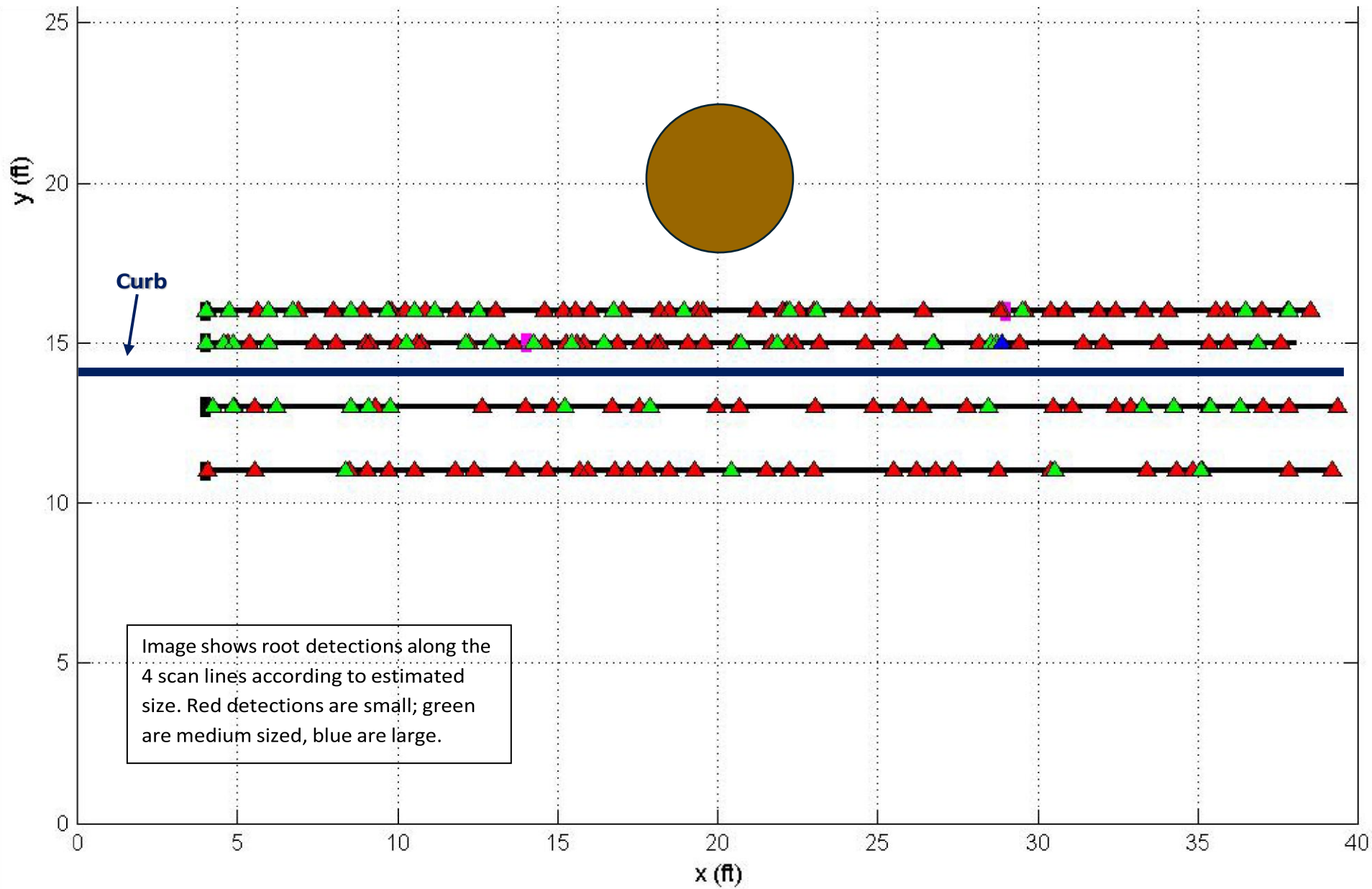

Top-Down View of Root Detections

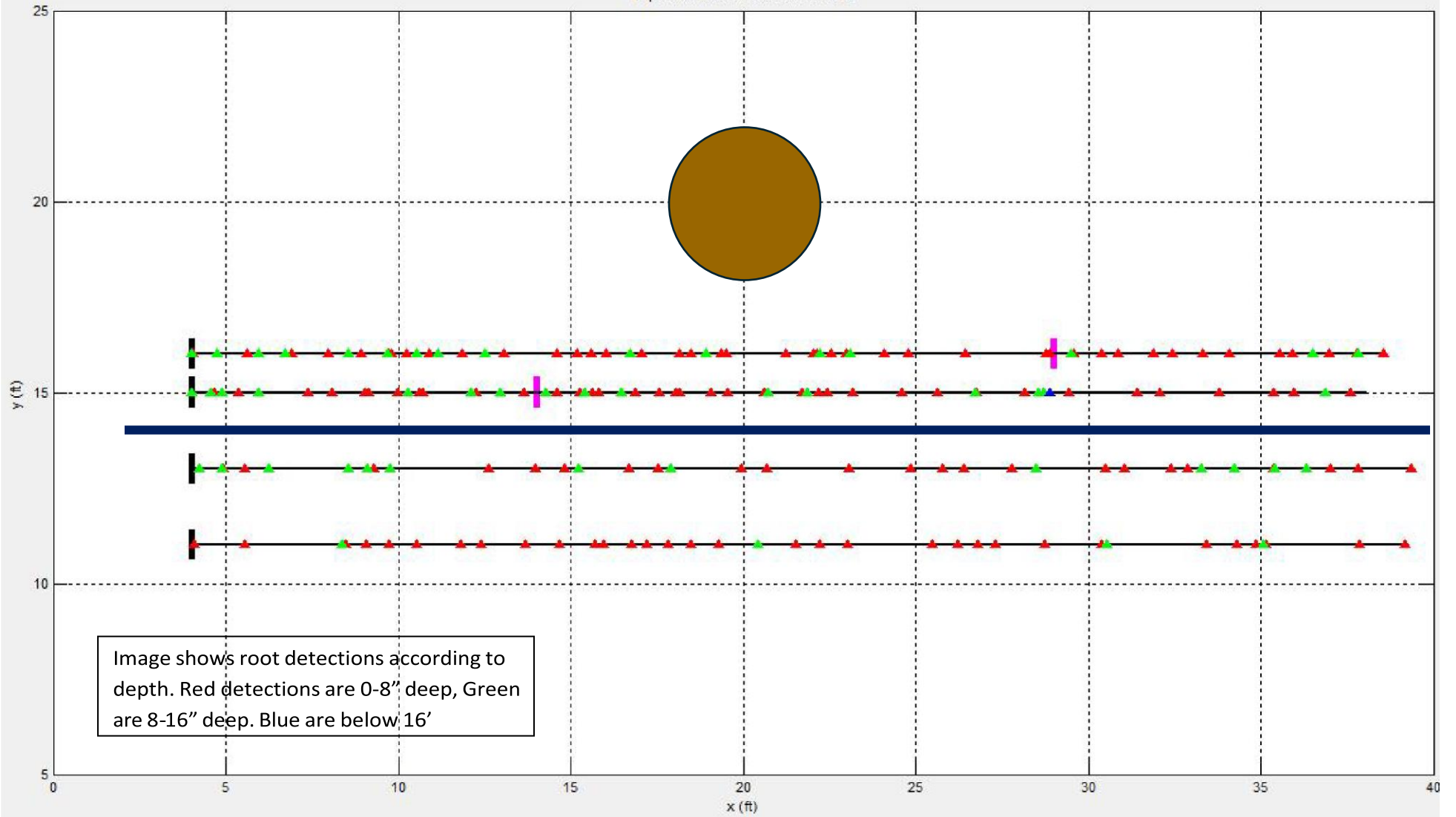

Top-Down Root Density Map

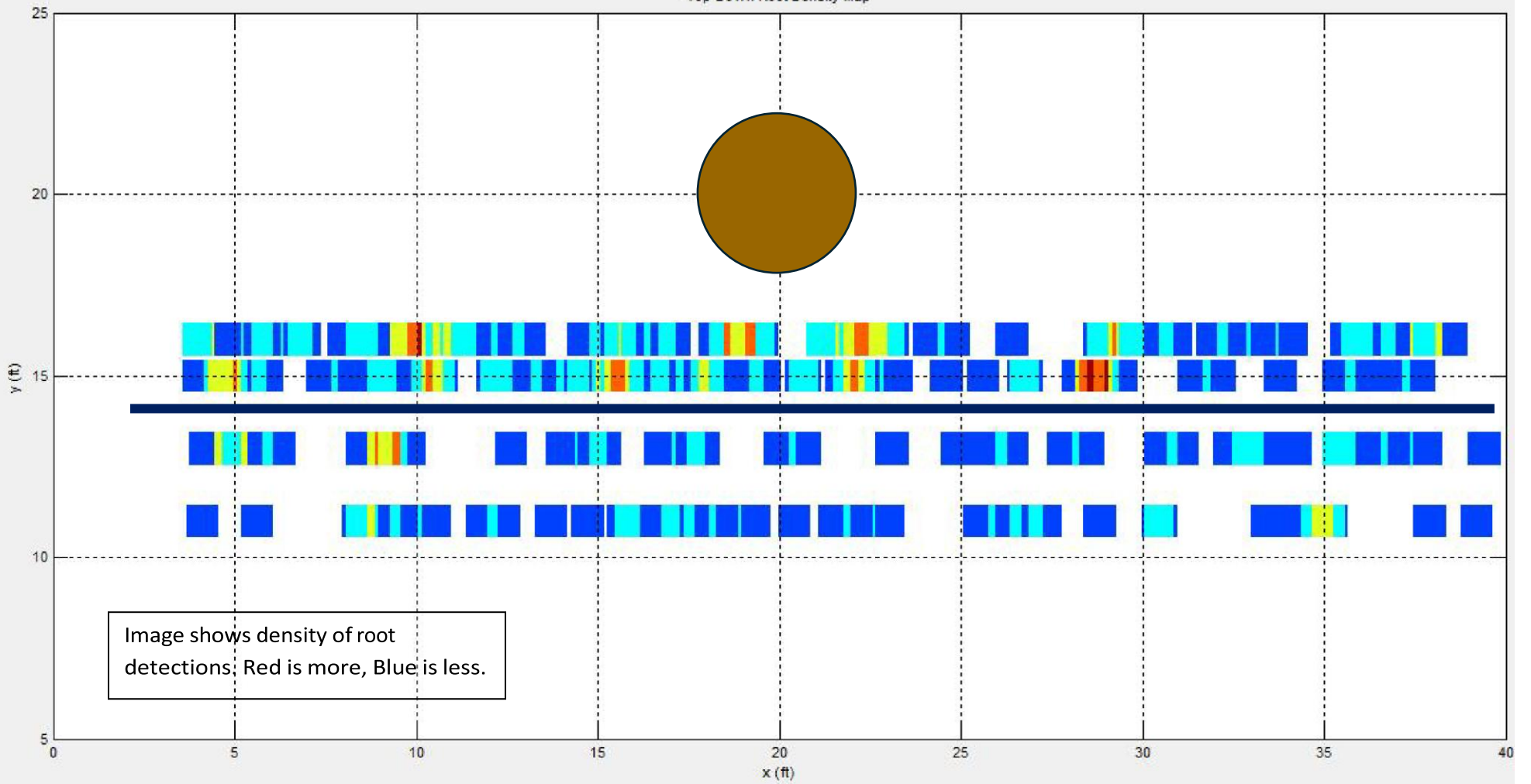

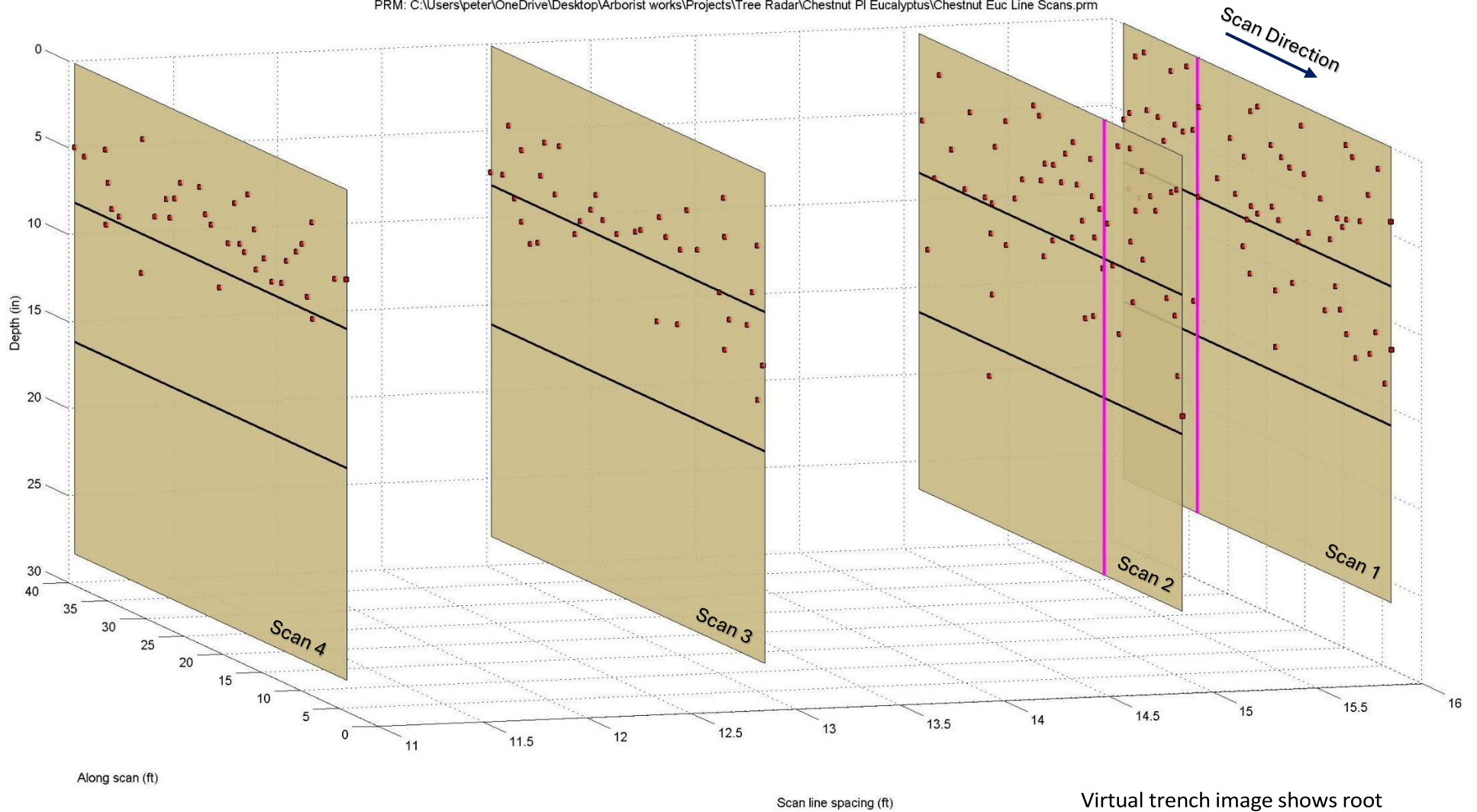

Virtual trench image shows root detections within a vertical plane for each scan line.

Root Morphology Map

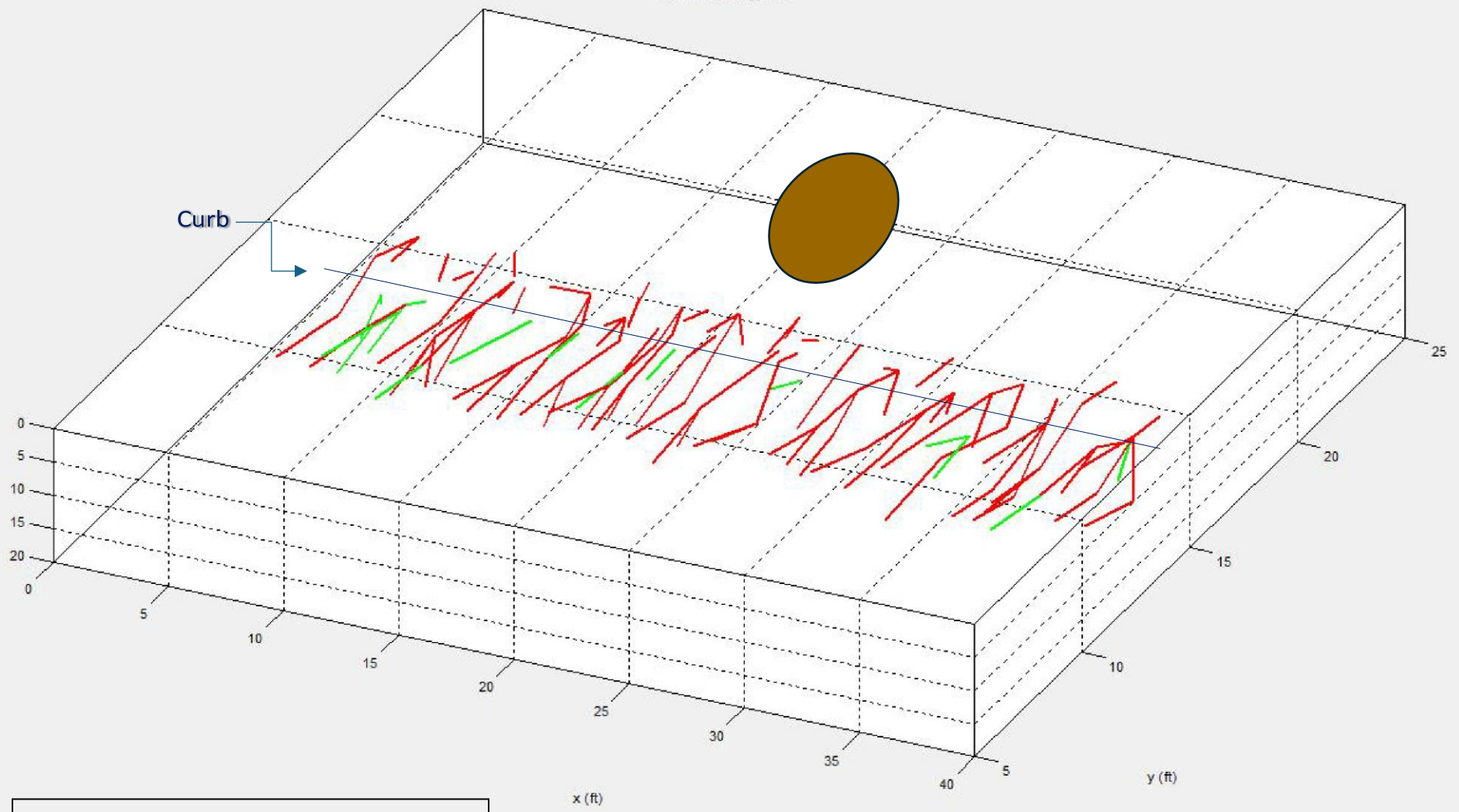

Image shows possible root morphology based on estimated root depth. Red is 0-8" deep, Green is 8-16" deep. Blue is below 16'

MORPHOLOGY: Red = Depth Zone 1, Green = Depth Zone 2, Blue = Depth Zone 3

Root Morphology Map

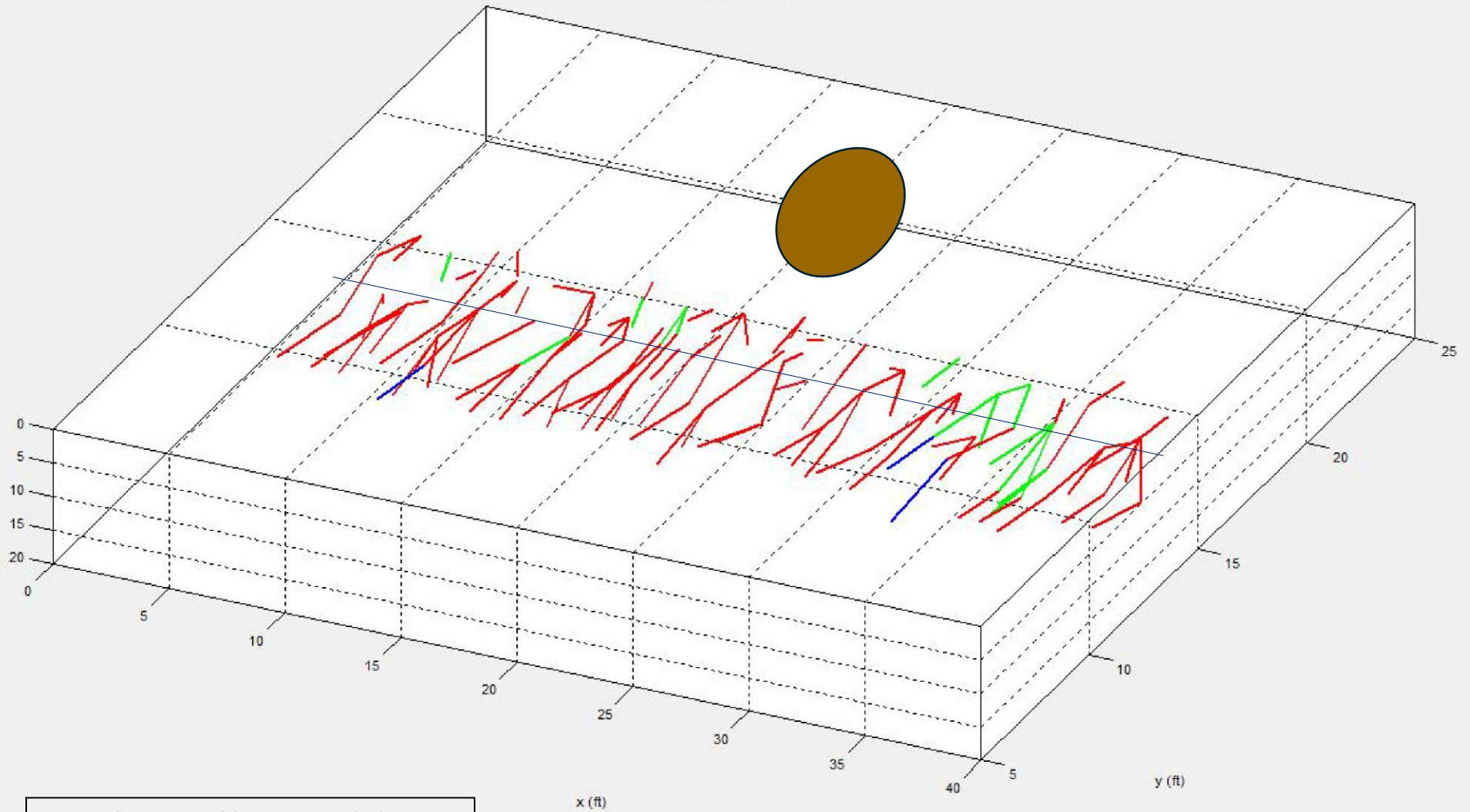

Image shows possible root morphology based on estimated root size. Red is small; green is medium sized, blue is large

MORPHOLOGY: Red = Estimated Small, Green = Estimated Medium, Blue = Estimated Large

DUDEK

27271 LAS RAMBLAS, SUITE 340
MISSION VIEJO, CALIFORNIA 92691
T 949.450.2525

MEMORANDUM

To: Kevin Pekar
From: Katrina Burritt
Subject: Peer Review of the Arborist Report for 901 Chestnut Place
Date: May 1, 2026
cc: John Nelson
Attachment(s): Arborist Report by Louis M. Hernandez Jr.

This memorandum provides the results of a third-party peer review of the Arborist Report (dated March 31, 2026) prepared by Louis M. Hernandez Jr. (WE-13022A). The property is located at 901 Chestnut Place in Newport Beach, California. The Arborist Report was prepared in response to the residents' concern over the stability of Tree ID 972864. A site visit was conducted by Dudek International Society of Arboriculture (ISA) Certified Arborist Katrina Burritt (WE-10771B) on April 28, 2026. Based upon the site visit and review of the Arborist Report, the report does not adequately describe the tree risk evaluation for the risk rating assigned to the subject tree. ISA provides industry standards for Tree Risk Assessments that have not been fully implemented during the tree risk evaluation and reporting.

1 Dudek's Literature Search

The following data sources were reviewed to assist with peer-review efforts:

- International Society of Arboriculture's (ISA) Best Management Practices (BMPs) Tree Risk Assessment Second Edition (ISA 2017);
- Tree Care Industry Association's (TCIA) ANSI A300 – 2023 Tree Care Standards Part 13: Tree Risk Assessment (TCIA 2023).

2 Peer-Review

Peer-Review of Property Description

Site Observations: Dudek's site visit has confirmed the location and setting description are generally correct. The Dudek arborist observed a visual difference in color in the gutter directly adjacent to the tree indicating that the concrete had been repaired since the original infrastructure was installed. However, displacement or color difference was not observed in the curb as was described in the Arborist Report.



Basic Tree Risk Assessment Form

Client: City of Newport Beach

Date: 4/28/2026

Time: 2:00PM

Address / Tree location: 901 Chestnut Place

Tree no.: 972864

Sheet: 1 of 2

Tree species: Eucalyptus viminalis

DBH: 52

Height (ft.): 68

Crown Spread Dia.(ft.): 60

Assessor(s): Katrina Burritt

Time frame: 1 year

Tools used: hypsometer

Target Assessment

Target number	Target description	Target zone			Occupancy rate 1 - rare 2 - occasional 3 - frequent 4 - constant	Practical to move target?	Restriction practical?
		Target within drip line	Target within 1 x Ht.	Target within 1.5 x Ht.			
1	Parked cars on street	<input checked="" type="checkbox"/>	<input checked="" type="checkbox"/>	<input checked="" type="checkbox"/>	2	No	No
2	Moving cars	<input checked="" type="checkbox"/>	<input checked="" type="checkbox"/>	<input checked="" type="checkbox"/>	2	No	No
3	Pedestrians, pets, cyclists, residents outside of homes in yards or driveways	<input checked="" type="checkbox"/>	<input checked="" type="checkbox"/>	<input checked="" type="checkbox"/>	2	No	No
4	House at 2719 Alta Vista	<input type="checkbox"/>	<input type="checkbox"/>	<input checked="" type="checkbox"/>	4	No	No
5	Front yard of 2719 Alta Vista	<input type="checkbox"/>	<input type="checkbox"/>	<input checked="" type="checkbox"/>	4	No	No
6	Parked cars at 2719 Alta Vista	<input type="checkbox"/>	<input type="checkbox"/>	<input checked="" type="checkbox"/>	3	No	No
7	Residents in 2719 Alta Vista	<input type="checkbox"/>	<input type="checkbox"/>	<input checked="" type="checkbox"/>	3	No	No
8	House at 901 Chestnut Place	<input type="checkbox"/>	<input checked="" type="checkbox"/>	<input checked="" type="checkbox"/>	4	No	No
9	Yard of 901 Chestnut Place	<input type="checkbox"/>	<input checked="" type="checkbox"/>	<input checked="" type="checkbox"/>	4	No	No
10	Residents in 901 Chestnut Place	<input type="checkbox"/>	<input checked="" type="checkbox"/>	<input checked="" type="checkbox"/>	3	No	No
11	Light pole	<input checked="" type="checkbox"/>	<input checked="" type="checkbox"/>	<input checked="" type="checkbox"/>	4	No	No

Site Factors

History of failures: Small limb in storm		Topography: Flat <input checked="" type="checkbox"/> Slope <input type="checkbox"/>		% Aspect:
Site changes: None <input type="checkbox"/> Grade change <input type="checkbox"/> Site clearing <input checked="" type="checkbox"/> Changed soil hydrology <input type="checkbox"/> Root cuts <input checked="" type="checkbox"/>				Describe: landscape renovation, with art. Turf installation
Soil conditions: Limited volume <input type="checkbox"/> Saturated <input type="checkbox"/> Shallow <input type="checkbox"/> Compacted <input type="checkbox"/> Pavement over roots <input checked="" type="checkbox"/>			80%	Describe: Street on NW side, sidewalk on SE side
Prevailing wind direction: W/SW	Common weather: Strong winds <input checked="" type="checkbox"/> Ice <input type="checkbox"/> Snow <input type="checkbox"/> Heavy rain <input checked="" type="checkbox"/>			Describe: Santa Ana winds, winter rainstorms

Tree Health and Species Profile

Vigor: Low <input type="checkbox"/> Normal <input checked="" type="checkbox"/> High <input type="checkbox"/>	Foliage: None (seasonal) <input type="checkbox"/> None (dead) <input type="checkbox"/>	Normal 99%	Chlorotic 1%	Necrotic 0%
Pests Paropsine leaf beetle		Abiotic unknown		
Species failure profile Branches <input checked="" type="checkbox"/> Trunk <input checked="" type="checkbox"/> Roots <input checked="" type="checkbox"/>				Describe: shallow roots, SBD

Load Factors

Wind exposure: Protected <input type="checkbox"/> Partial <input type="checkbox"/> Full <input checked="" type="checkbox"/> Wind funneling <input type="checkbox"/>	Relative crown size: Small <input type="checkbox"/> Medium <input type="checkbox"/> Large <input checked="" type="checkbox"/>
Crown density: Sparse <input checked="" type="checkbox"/> Normal <input type="checkbox"/> Dense <input type="checkbox"/>	Interior branches: Few <input checked="" type="checkbox"/> Normal <input type="checkbox"/> Dense <input type="checkbox"/>
Vines/Mistletoe/Moss: None	

Recent or planned change in load factors: tree has been topped, height reduced by 15%

Tree Defects and Conditions Affecting the Likelihood of Conflict

— Crown and Branches —

Unbalanced crown <input type="checkbox"/>	LCR 84%	Cracks <input type="checkbox"/> Describe:	Lightning damage <input type="checkbox"/>
Dead twigs/branches <input type="checkbox"/>	0% overall	Max. dia.	Codominant <input checked="" type="checkbox"/> Describe: small scaffold branches
Broken/Hangers Number:	Max. dia:	Weak attachments <input checked="" type="checkbox"/>	Cavity/Nest hole .5 % circ.
Over-extended branches <input type="checkbox"/>			
Pruning history		Previous branch failures <input checked="" type="checkbox"/> Describe: small terminal branch	Similar branches present <input checked="" type="checkbox"/>
Crown cleaned <input checked="" type="checkbox"/>	Thinned <input type="checkbox"/>	Raised <input type="checkbox"/>	Dead/Missing bark <input type="checkbox"/>
		Cankers/Galls/Burls <input checked="" type="checkbox"/>	Sapwood damage/decay <input type="checkbox"/>
Reduced <input checked="" type="checkbox"/>	Topped <input checked="" type="checkbox"/>	Lion-tailed <input checked="" type="checkbox"/>	Conks <input type="checkbox"/>
		Heartwood decay <input checked="" type="checkbox"/>	Describe: 5" scaffold branch with heartwood decay & nest hole
Flush cuts <input checked="" type="checkbox"/>	Other:	Response growth: None	
Main concern(s): increased load on small to medium sized scaffold branches due to recent pruning			
Load on defect N/A <input type="checkbox"/> Minor <input type="checkbox"/> Moderate <input checked="" type="checkbox"/> Significant <input type="checkbox"/>			Describe: normal winds are 10-15mph
Likelihood of failure Improbable <input type="checkbox"/> Possible <input type="checkbox"/> Probable <input checked="" type="checkbox"/> Imminent <input type="checkbox"/>			Describe:

— Trunk —

Dead/Missing bark <input type="checkbox"/>	Abnormal bark texture/color <input type="checkbox"/>
Codominant stems <input type="checkbox"/>	Included bark <input type="checkbox"/>
Sapwood damage/decay <input type="checkbox"/>	Cracks <input type="checkbox"/>
Lightning damage <input type="checkbox"/>	Cankers/Galls/Burls <input type="checkbox"/>
Cavity/Nest hole: % circ.	Sap ooze <input type="checkbox"/>
Lean: 6 degrees towards the west	Heartwood decay <input type="checkbox"/>
Response growth: None	Conks/Mushrooms <input type="checkbox"/>
Main concern(s): None	Depth:
Load on defect N/A <input type="checkbox"/> Minor <input type="checkbox"/> Moderate <input type="checkbox"/> Significant <input checked="" type="checkbox"/>	Poor taper <input type="checkbox"/>
Likelihood of failure Improbable <input checked="" type="checkbox"/> Possible <input type="checkbox"/> Probable <input type="checkbox"/> Imminent <input type="checkbox"/>	Corrected?: yes

— Roots and Root Collar —

Collar buried/Not visible <input type="checkbox"/>	Depth:	Stem girdling <input type="checkbox"/>
Dead <input checked="" type="checkbox"/>	Decay <input checked="" type="checkbox"/>	Conks/Mushrooms <input type="checkbox"/>
Ooze <input type="checkbox"/>	Cavity <input checked="" type="checkbox"/>	2 % circ.
Cracks <input type="checkbox"/>	Cut/Damaged roots <input checked="" type="checkbox"/>	Distance from trunk: 2ft
Root plate lifting <input type="checkbox"/>	Soil weakness <input type="checkbox"/>	
Response growth: None		
Main concern(s): Heartwood decay in root collar and past root damage		
Load on defect N/A <input type="checkbox"/> Minor <input type="checkbox"/> Moderate <input type="checkbox"/> Significant <input checked="" type="checkbox"/>		
Likelihood of failure Improbable <input type="checkbox"/> Possible <input checked="" type="checkbox"/> Probable <input type="checkbox"/> Imminent <input type="checkbox"/>		

Risk Categorization

Condition number	Tree part	Conditions of concern	Part size	Fall distance	Target number	Target protection	Likelihood																Risk rating of part (from Matrix 2)
							Failure				Impact				Failure & Impact (from Matrix 1)				Consequences				
							Improbabi	Possible	Probable	Imminent	Very low	Low	Medium	High	Unlikely	Somewha	Likely	Very likely	Negligible	Minor	Significant	Severe	
1	Crown	Scaffold branch failure	7"	20	1	No	<input type="checkbox"/>	<input type="checkbox"/>	<input checked="" type="checkbox"/>	<input type="checkbox"/>	<input type="checkbox"/>	<input checked="" type="checkbox"/>	<input type="checkbox"/>	<input type="checkbox"/>	<input checked="" type="checkbox"/>	<input type="checkbox"/>	<input type="checkbox"/>	<input type="checkbox"/>	<input type="checkbox"/>	<input type="checkbox"/>	<input checked="" type="checkbox"/>	<input type="checkbox"/>	Low
			7"	20	2	No	<input type="checkbox"/>	<input type="checkbox"/>	<input checked="" type="checkbox"/>	<input type="checkbox"/>	<input checked="" type="checkbox"/>	<input type="checkbox"/>	<input type="checkbox"/>	<input type="checkbox"/>	<input checked="" type="checkbox"/>	<input type="checkbox"/>	<input type="checkbox"/>	<input type="checkbox"/>	<input type="checkbox"/>	<input type="checkbox"/>	<input checked="" type="checkbox"/>	<input type="checkbox"/>	Low
			7"	30	3	No	<input type="checkbox"/>	<input type="checkbox"/>	<input checked="" type="checkbox"/>	<input type="checkbox"/>	<input checked="" type="checkbox"/>	<input type="checkbox"/>	<input type="checkbox"/>	<input type="checkbox"/>	<input checked="" type="checkbox"/>	<input type="checkbox"/>	<input type="checkbox"/>	<input type="checkbox"/>	<input type="checkbox"/>	<input type="checkbox"/>	<input type="checkbox"/>	<input checked="" type="checkbox"/>	Low
			7"	85	4	No	<input type="checkbox"/>	<input type="checkbox"/>	<input checked="" type="checkbox"/>	<input type="checkbox"/>	<input checked="" type="checkbox"/>	<input type="checkbox"/>	<input type="checkbox"/>	<input type="checkbox"/>	<input checked="" type="checkbox"/>	<input type="checkbox"/>	<input type="checkbox"/>	<input type="checkbox"/>	<input type="checkbox"/>	<input checked="" type="checkbox"/>	<input type="checkbox"/>	<input type="checkbox"/>	Low
			7"	75	5	No	<input type="checkbox"/>	<input type="checkbox"/>	<input checked="" type="checkbox"/>	<input type="checkbox"/>	<input type="checkbox"/>	<input checked="" type="checkbox"/>	<input type="checkbox"/>	<input type="checkbox"/>	<input checked="" type="checkbox"/>	<input type="checkbox"/>	<input type="checkbox"/>	<input type="checkbox"/>	<input checked="" type="checkbox"/>	<input type="checkbox"/>	<input type="checkbox"/>	<input type="checkbox"/>	Low
			7"	75	6	No	<input type="checkbox"/>	<input type="checkbox"/>	<input checked="" type="checkbox"/>	<input type="checkbox"/>	<input type="checkbox"/>	<input checked="" type="checkbox"/>	<input type="checkbox"/>	<input type="checkbox"/>	<input checked="" type="checkbox"/>	<input type="checkbox"/>	<input type="checkbox"/>	<input type="checkbox"/>	<input type="checkbox"/>	<input type="checkbox"/>	<input checked="" type="checkbox"/>	<input type="checkbox"/>	Low
			7"	90	7	Yes	<input type="checkbox"/>	<input type="checkbox"/>	<input checked="" type="checkbox"/>	<input type="checkbox"/>	<input checked="" type="checkbox"/>	<input type="checkbox"/>	<input type="checkbox"/>	<input type="checkbox"/>	<input checked="" type="checkbox"/>	<input type="checkbox"/>	<input type="checkbox"/>	<input type="checkbox"/>	<input type="checkbox"/>	<input type="checkbox"/>	<input type="checkbox"/>	<input checked="" type="checkbox"/>	Low
			7"	50	8	No	<input type="checkbox"/>	<input type="checkbox"/>	<input checked="" type="checkbox"/>	<input type="checkbox"/>	<input type="checkbox"/>	<input checked="" type="checkbox"/>	<input type="checkbox"/>	<input type="checkbox"/>	<input checked="" type="checkbox"/>	<input type="checkbox"/>	<input type="checkbox"/>	<input type="checkbox"/>	<input type="checkbox"/>	<input checked="" type="checkbox"/>	<input type="checkbox"/>	<input type="checkbox"/>	Low
			7"	20	9	No	<input type="checkbox"/>	<input type="checkbox"/>	<input checked="" type="checkbox"/>	<input type="checkbox"/>	<input type="checkbox"/>	<input type="checkbox"/>	<input checked="" type="checkbox"/>	<input type="checkbox"/>	<input type="checkbox"/>	<input checked="" type="checkbox"/>	<input type="checkbox"/>	<input type="checkbox"/>	<input type="checkbox"/>	<input checked="" type="checkbox"/>	<input type="checkbox"/>	<input type="checkbox"/>	Low
			7"	60	10	Yes	<input type="checkbox"/>	<input type="checkbox"/>	<input checked="" type="checkbox"/>	<input type="checkbox"/>	<input type="checkbox"/>	<input checked="" type="checkbox"/>	<input type="checkbox"/>	<input type="checkbox"/>	<input checked="" type="checkbox"/>	<input type="checkbox"/>	<input type="checkbox"/>	<input type="checkbox"/>	<input type="checkbox"/>	<input type="checkbox"/>	<input type="checkbox"/>	<input checked="" type="checkbox"/>	Low
			7"	10	11	No	<input type="checkbox"/>	<input type="checkbox"/>	<input checked="" type="checkbox"/>	<input type="checkbox"/>	<input type="checkbox"/>	<input type="checkbox"/>	<input checked="" type="checkbox"/>	<input type="checkbox"/>	<input type="checkbox"/>	<input checked="" type="checkbox"/>	<input type="checkbox"/>	<input type="checkbox"/>	<input checked="" type="checkbox"/>	<input type="checkbox"/>	<input type="checkbox"/>	<input type="checkbox"/>	Low
2	Trunk	None	52"	20	1	No	<input checked="" type="checkbox"/>	<input type="checkbox"/>	<input type="checkbox"/>	<input type="checkbox"/>	<input type="checkbox"/>	<input checked="" type="checkbox"/>	<input type="checkbox"/>	<input type="checkbox"/>	<input checked="" type="checkbox"/>	<input type="checkbox"/>	<input type="checkbox"/>	<input type="checkbox"/>	<input type="checkbox"/>	<input type="checkbox"/>	<input checked="" type="checkbox"/>	<input type="checkbox"/>	Low
			52"	20	2	No	<input checked="" type="checkbox"/>	<input type="checkbox"/>	<input type="checkbox"/>	<input type="checkbox"/>	<input checked="" type="checkbox"/>	<input type="checkbox"/>	<input type="checkbox"/>	<input type="checkbox"/>	<input checked="" type="checkbox"/>	<input type="checkbox"/>	<input type="checkbox"/>	<input type="checkbox"/>	<input type="checkbox"/>	<input type="checkbox"/>	<input checked="" type="checkbox"/>	<input type="checkbox"/>	Low
			52"	30	3	No	<input checked="" type="checkbox"/>	<input type="checkbox"/>	<input type="checkbox"/>	<input type="checkbox"/>	<input checked="" type="checkbox"/>	<input type="checkbox"/>	<input type="checkbox"/>	<input type="checkbox"/>	<input checked="" type="checkbox"/>	<input type="checkbox"/>	<input type="checkbox"/>	<input type="checkbox"/>	<input type="checkbox"/>	<input type="checkbox"/>	<input type="checkbox"/>	<input checked="" type="checkbox"/>	Low
			52"	85	4	No	<input checked="" type="checkbox"/>	<input type="checkbox"/>	<input type="checkbox"/>	<input type="checkbox"/>	<input type="checkbox"/>	<input checked="" type="checkbox"/>	<input type="checkbox"/>	<input type="checkbox"/>	<input checked="" type="checkbox"/>	<input type="checkbox"/>	<input type="checkbox"/>	<input type="checkbox"/>	<input type="checkbox"/>	<input checked="" type="checkbox"/>	<input type="checkbox"/>	<input type="checkbox"/>	Low
			52"	75	5	No	<input checked="" type="checkbox"/>	<input type="checkbox"/>	<input type="checkbox"/>	<input type="checkbox"/>	<input type="checkbox"/>	<input type="checkbox"/>	<input checked="" type="checkbox"/>	<input type="checkbox"/>	<input checked="" type="checkbox"/>	<input type="checkbox"/>	<input type="checkbox"/>	<input type="checkbox"/>	<input type="checkbox"/>	<input checked="" type="checkbox"/>	<input type="checkbox"/>	<input type="checkbox"/>	Low
			52"	75	6	No	<input checked="" type="checkbox"/>	<input type="checkbox"/>	<input type="checkbox"/>	<input type="checkbox"/>	<input type="checkbox"/>	<input checked="" type="checkbox"/>	<input type="checkbox"/>	<input type="checkbox"/>	<input checked="" type="checkbox"/>	<input type="checkbox"/>	<input type="checkbox"/>	<input type="checkbox"/>	<input type="checkbox"/>	<input type="checkbox"/>	<input checked="" type="checkbox"/>	<input type="checkbox"/>	Low
			52"	90	7	Yes	<input checked="" type="checkbox"/>	<input type="checkbox"/>	<input type="checkbox"/>	<input type="checkbox"/>	<input type="checkbox"/>	<input checked="" type="checkbox"/>	<input type="checkbox"/>	<input type="checkbox"/>	<input checked="" type="checkbox"/>	<input type="checkbox"/>	<input type="checkbox"/>	<input type="checkbox"/>	<input type="checkbox"/>	<input type="checkbox"/>	<input type="checkbox"/>	<input checked="" type="checkbox"/>	Low
			52"	50	8	No	<input checked="" type="checkbox"/>	<input type="checkbox"/>	<input type="checkbox"/>	<input type="checkbox"/>	<input type="checkbox"/>	<input type="checkbox"/>	<input checked="" type="checkbox"/>	<input type="checkbox"/>	<input checked="" type="checkbox"/>	<input type="checkbox"/>	<input type="checkbox"/>	<input type="checkbox"/>	<input type="checkbox"/>	<input type="checkbox"/>	<input checked="" type="checkbox"/>	<input type="checkbox"/>	Low
			52"	20	9	No	<input checked="" type="checkbox"/>	<input type="checkbox"/>	<input type="checkbox"/>	<input type="checkbox"/>	<input type="checkbox"/>	<input type="checkbox"/>	<input checked="" type="checkbox"/>	<input type="checkbox"/>	<input checked="" type="checkbox"/>	<input type="checkbox"/>	<input type="checkbox"/>	<input type="checkbox"/>	<input type="checkbox"/>	<input checked="" type="checkbox"/>	<input type="checkbox"/>	<input type="checkbox"/>	Low
			52"	60	10	Yes	<input checked="" type="checkbox"/>	<input type="checkbox"/>	<input type="checkbox"/>	<input type="checkbox"/>	<input type="checkbox"/>	<input checked="" type="checkbox"/>	<input type="checkbox"/>	<input type="checkbox"/>	<input checked="" type="checkbox"/>	<input type="checkbox"/>	<input type="checkbox"/>	<input type="checkbox"/>	<input type="checkbox"/>	<input type="checkbox"/>	<input type="checkbox"/>	<input checked="" type="checkbox"/>	Low
			52"	10	11	No	<input checked="" type="checkbox"/>	<input type="checkbox"/>	<input type="checkbox"/>	<input type="checkbox"/>	<input type="checkbox"/>	<input type="checkbox"/>	<input checked="" type="checkbox"/>	<input type="checkbox"/>	<input checked="" type="checkbox"/>	<input type="checkbox"/>	<input type="checkbox"/>	<input type="checkbox"/>	<input checked="" type="checkbox"/>	<input type="checkbox"/>	<input type="checkbox"/>	<input type="checkbox"/>	Low
3	Roots	Decayed root collar and damaged roots	52"	20	1	No	<input type="checkbox"/>	<input checked="" type="checkbox"/>	<input type="checkbox"/>	<input type="checkbox"/>	<input type="checkbox"/>	<input checked="" type="checkbox"/>	<input type="checkbox"/>	<input type="checkbox"/>	<input checked="" type="checkbox"/>	<input type="checkbox"/>	<input type="checkbox"/>	<input type="checkbox"/>	<input type="checkbox"/>	<input type="checkbox"/>	<input checked="" type="checkbox"/>	<input type="checkbox"/>	Low
			52"	20	2	No	<input type="checkbox"/>	<input checked="" type="checkbox"/>	<input type="checkbox"/>	<input type="checkbox"/>	<input checked="" type="checkbox"/>	<input type="checkbox"/>	<input type="checkbox"/>	<input type="checkbox"/>	<input checked="" type="checkbox"/>	<input type="checkbox"/>	<input type="checkbox"/>	<input type="checkbox"/>	<input type="checkbox"/>	<input type="checkbox"/>	<input checked="" type="checkbox"/>	<input type="checkbox"/>	Low
			52"	30	3	No	<input type="checkbox"/>	<input checked="" type="checkbox"/>	<input type="checkbox"/>	<input type="checkbox"/>	<input checked="" type="checkbox"/>	<input type="checkbox"/>	<input type="checkbox"/>	<input type="checkbox"/>	<input checked="" type="checkbox"/>	<input type="checkbox"/>	<input type="checkbox"/>	<input type="checkbox"/>	<input type="checkbox"/>	<input type="checkbox"/>	<input type="checkbox"/>	<input checked="" type="checkbox"/>	Low
			52"	85	4	No	<input type="checkbox"/>	<input checked="" type="checkbox"/>	<input type="checkbox"/>	<input type="checkbox"/>	<input type="checkbox"/>	<input checked="" type="checkbox"/>	<input type="checkbox"/>	<input type="checkbox"/>	<input checked="" type="checkbox"/>	<input type="checkbox"/>	<input type="checkbox"/>	<input type="checkbox"/>	<input type="checkbox"/>	<input checked="" type="checkbox"/>	<input type="checkbox"/>	<input type="checkbox"/>	Low
			52"	75	5	No	<input type="checkbox"/>	<input checked="" type="checkbox"/>	<input type="checkbox"/>	<input type="checkbox"/>	<input type="checkbox"/>	<input type="checkbox"/>	<input checked="" type="checkbox"/>	<input type="checkbox"/>	<input checked="" type="checkbox"/>	<input type="checkbox"/>	<input type="checkbox"/>	<input type="checkbox"/>	<input checked="" type="checkbox"/>	<input type="checkbox"/>	<input type="checkbox"/>	<input type="checkbox"/>	Low
			52"	75	6	No	<input type="checkbox"/>	<input checked="" type="checkbox"/>	<input type="checkbox"/>	<input type="checkbox"/>	<input type="checkbox"/>	<input checked="" type="checkbox"/>	<input type="checkbox"/>	<input type="checkbox"/>	<input checked="" type="checkbox"/>	<input type="checkbox"/>	<input type="checkbox"/>	<input type="checkbox"/>	<input type="checkbox"/>	<input type="checkbox"/>	<input checked="" type="checkbox"/>	<input type="checkbox"/>	Low
			52"	90	7	Yes	<input type="checkbox"/>	<input checked="" type="checkbox"/>	<input type="checkbox"/>	<input type="checkbox"/>	<input type="checkbox"/>	<input checked="" type="checkbox"/>	<input type="checkbox"/>	<input type="checkbox"/>	<input checked="" type="checkbox"/>	<input type="checkbox"/>	<input type="checkbox"/>	<input type="checkbox"/>	<input type="checkbox"/>	<input type="checkbox"/>	<input type="checkbox"/>	<input checked="" type="checkbox"/>	Low
			52"	50	8	No	<input type="checkbox"/>	<input checked="" type="checkbox"/>	<input type="checkbox"/>	<input type="checkbox"/>	<input type="checkbox"/>	<input type="checkbox"/>	<input checked="" type="checkbox"/>	<input type="checkbox"/>	<input type="checkbox"/>	<input checked="" type="checkbox"/>	<input type="checkbox"/>	<input type="checkbox"/>	<input type="checkbox"/>	<input type="checkbox"/>	<input checked="" type="checkbox"/>	<input type="checkbox"/>	Mod
			52"	20	9	No	<input type="checkbox"/>	<input checked="" type="checkbox"/>	<input type="checkbox"/>	<input type="checkbox"/>	<input type="checkbox"/>	<input type="checkbox"/>	<input checked="" type="checkbox"/>	<input type="checkbox"/>	<input type="checkbox"/>	<input checked="" type="checkbox"/>	<input type="checkbox"/>	<input type="checkbox"/>	<input type="checkbox"/>	<input checked="" type="checkbox"/>	<input type="checkbox"/>	<input type="checkbox"/>	Low
			52"	60	10	Yes	<input type="checkbox"/>	<input checked="" type="checkbox"/>	<input type="checkbox"/>	<input type="checkbox"/>	<input type="checkbox"/>	<input checked="" type="checkbox"/>	<input type="checkbox"/>	<input type="checkbox"/>	<input checked="" type="checkbox"/>	<input type="checkbox"/>	<input type="checkbox"/>	<input type="checkbox"/>	<input type="checkbox"/>	<input type="checkbox"/>	<input type="checkbox"/>	<input checked="" type="checkbox"/>	Low
			52"	10	11	No	<input type="checkbox"/>	<input checked="" type="checkbox"/>	<input type="checkbox"/>	<input type="checkbox"/>	<input type="checkbox"/>	<input type="checkbox"/>	<input checked="" type="checkbox"/>	<input type="checkbox"/>	<input checked="" type="checkbox"/>	<input type="checkbox"/>	<input type="checkbox"/>	<input type="checkbox"/>	<input checked="" type="checkbox"/>	<input type="checkbox"/>	<input type="checkbox"/>	<input type="checkbox"/>	Low
4							<input type="checkbox"/>	<input type="checkbox"/>	<input type="checkbox"/>	<input type="checkbox"/>	<input type="checkbox"/>	<input type="checkbox"/>	<input type="checkbox"/>	<input type="checkbox"/>	<input type="checkbox"/>	<input type="checkbox"/>	<input type="checkbox"/>	<input type="checkbox"/>	<input type="checkbox"/>	<input type="checkbox"/>	<input type="checkbox"/>	<input type="checkbox"/>	
							<input type="checkbox"/>	<input type="checkbox"/>	<input type="checkbox"/>	<input type="checkbox"/>	<input type="checkbox"/>	<input type="checkbox"/>	<input type="checkbox"/>	<input type="checkbox"/>	<input type="checkbox"/>	<input type="checkbox"/>	<input type="checkbox"/>	<input type="checkbox"/>	<input type="checkbox"/>	<input type="checkbox"/>	<input type="checkbox"/>	<input type="checkbox"/>	
							<input type="checkbox"/>	<input type="checkbox"/>	<input type="checkbox"/>	<input type="checkbox"/>	<input type="checkbox"/>	<input type="checkbox"/>	<input type="checkbox"/>	<input type="checkbox"/>	<input type="checkbox"/>	<input type="checkbox"/>	<input type="checkbox"/>	<input type="checkbox"/>	<input type="checkbox"/>	<input type="checkbox"/>	<input type="checkbox"/>	<input type="checkbox"/>	
							<input type="checkbox"/>	<input type="checkbox"/>	<input type="checkbox"/>	<input type="checkbox"/>	<input type="checkbox"/>	<input type="checkbox"/>	<input type="checkbox"/>	<input type="checkbox"/>	<input type="checkbox"/>	<input type="checkbox"/>	<input type="checkbox"/>	<input type="checkbox"/>	<input type="checkbox"/>	<input type="checkbox"/>	<input type="checkbox"/>	<input type="checkbox"/>	
							<input type="checkbox"/>	<input type="checkbox"/>	<input type="checkbox"/>	<input type="checkbox"/>	<input type="checkbox"/>	<input type="checkbox"/>	<input type="checkbox"/>	<input type="checkbox"/>	<input type="checkbox"/>	<input type="checkbox"/>	<input type="checkbox"/>	<input type="checkbox"/>	<input type="checkbox"/>	<input type="checkbox"/>	<input type="checkbox"/>	<input type="checkbox"/>	
							<input type="checkbox"/>	<input type="checkbox"/>	<input type="checkbox"/>	<input type="checkbox"/>	<input type="checkbox"/>	<input type="checkbox"/>	<input type="checkbox"/>	<input type="checkbox"/>	<input type="checkbox"/>	<input type="checkbox"/>	<input type="checkbox"/>	<input type="checkbox"/>	<input type="checkbox"/>	<input type="checkbox"/>	<input type="checkbox"/>	<input type="checkbox"/>	
							<input type="checkbox"/>	<input type="checkbox"/>	<input type="checkbox"/>	<input type="checkbox"/>	<input type="checkbox"/>	<input type="checkbox"/>	<input type="checkbox"/>	<input type="checkbox"/>	<input type="checkbox"/>	<input type="checkbox"/>	<input type="checkbox"/>	<input type="checkbox"/>	<input type="checkbox"/>	<input type="checkbox"/>	<input type="checkbox"/>	<input type="checkbox"/>	
							<input type="checkbox"/>	<input type="checkbox"/>	<input type="checkbox"/>	<input type="checkbox"/>	<input type="checkbox"/>	<input type="checkbox"/>	<input type="checkbox"/>	<input type="checkbox"/>	<input type="checkbox"/>	<input type="checkbox"/>	<input type="checkbox"/>	<input type="checkbox"/>	<input type="checkbox"/>	<input type="checkbox"/>	<input type="checkbox"/>	<input type="checkbox"/>	
							<input type="checkbox"/>	<input type="checkbox"/>	<input type="checkbox"/>	<input type="checkbox"/>	<input type="checkbox"/>	<input type="checkbox"/>	<input type="checkbox"/>	<input type="checkbox"/>	<input type="checkbox"/>	<input type="checkbox"/>	<input type="checkbox"/>	<input type="checkbox"/>	<input type="checkbox"/>	<input type="checkbox"/>	<input type="checkbox"/>	<input type="checkbox"/>	
							<input type="checkbox"/>	<input type="checkbox"/>	<input type="checkbox"/>	<input type="checkbox"/>	<input type="checkbox"/>	<input type="checkbox"/>	<input type="checkbox"/>	<input type="checkbox"/>	<input type="checkbox"/>	<input type="checkbox"/>	<input type="checkbox"/>	<input type="checkbox"/>	<input type="checkbox"/>	<input type="checkbox"/>	<input type="checkbox"/>	<input type="checkbox"/>	

Matrix1. Likelihood matrix.

Likelihood of Failure	Likelihood of Impacting Target			
	Very low	Low	Medium	High
Imminent	Unlikely	Somewhat likely	Likely	Very likely
Probable	Unlikely	Unlikely	Somewhat likely	Likely
Possible	Unlikely	Unlikely	Unlikely	Somewhat likely
Improbable	Unlikely	Unlikely	Unlikely	Unlikely

Matrix2. Risk rating matrix.

Likelihood of Failure & Impact	Consequences of Failure			
	Negligible	Minor	Significant	Severe
Very likely	Low	Moderate	High	Extreme
Likely	Low	Moderate	High	High
Somewhat likely	Low	Low	Moderate	Moderate
Unlikely	Low	Low	Low	Low

Notes, explanations, descriptions:

Sidewalk has been ground down, but doesn't appear to have been replaced

Gutter appears to have been replaced

Cavity in root collar; wind coming from south/southwest

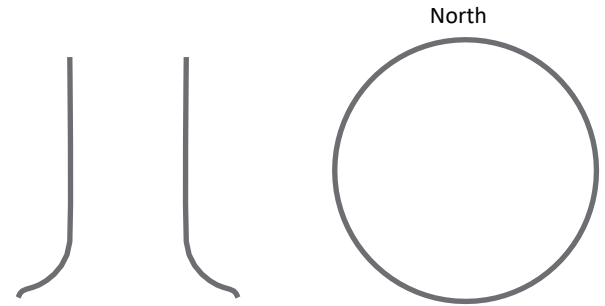
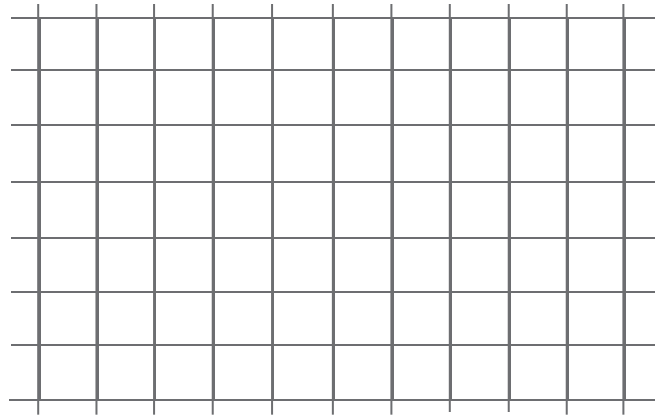

Mitigation options		
Level 3 sonic tomography		Residual risk: Moderate
Tree removal		Residual risk: None
		Residual risk:
Overall tree risk rating Low <input type="checkbox"/> Moderate <input checked="" type="checkbox"/> High <input type="checkbox"/> Extreme <input type="checkbox"/>		Work priority 1 <input checked="" type="checkbox"/> 2 <input type="checkbox"/> 3 <input type="checkbox"/> 4 <input type="checkbox"/>
Overall residual risk Low <input type="checkbox"/> Moderate <input checked="" type="checkbox"/> High <input type="checkbox"/> Extreme <input type="checkbox"/>		Recommended inspection interval: 1 year
Data <input checked="" type="checkbox"/> Final <input type="checkbox"/> Preliminary	Advanced assessment needed <input checked="" type="checkbox"/> No <input type="checkbox"/> Yes	Type/Reason: Sonic Tomography
Inspection limitations <input type="checkbox"/> None <input checked="" type="checkbox"/> Visibility <input type="checkbox"/> Access <input type="checkbox"/> Vines <input type="checkbox"/> Root collar buried		Describe: Ground level inspection

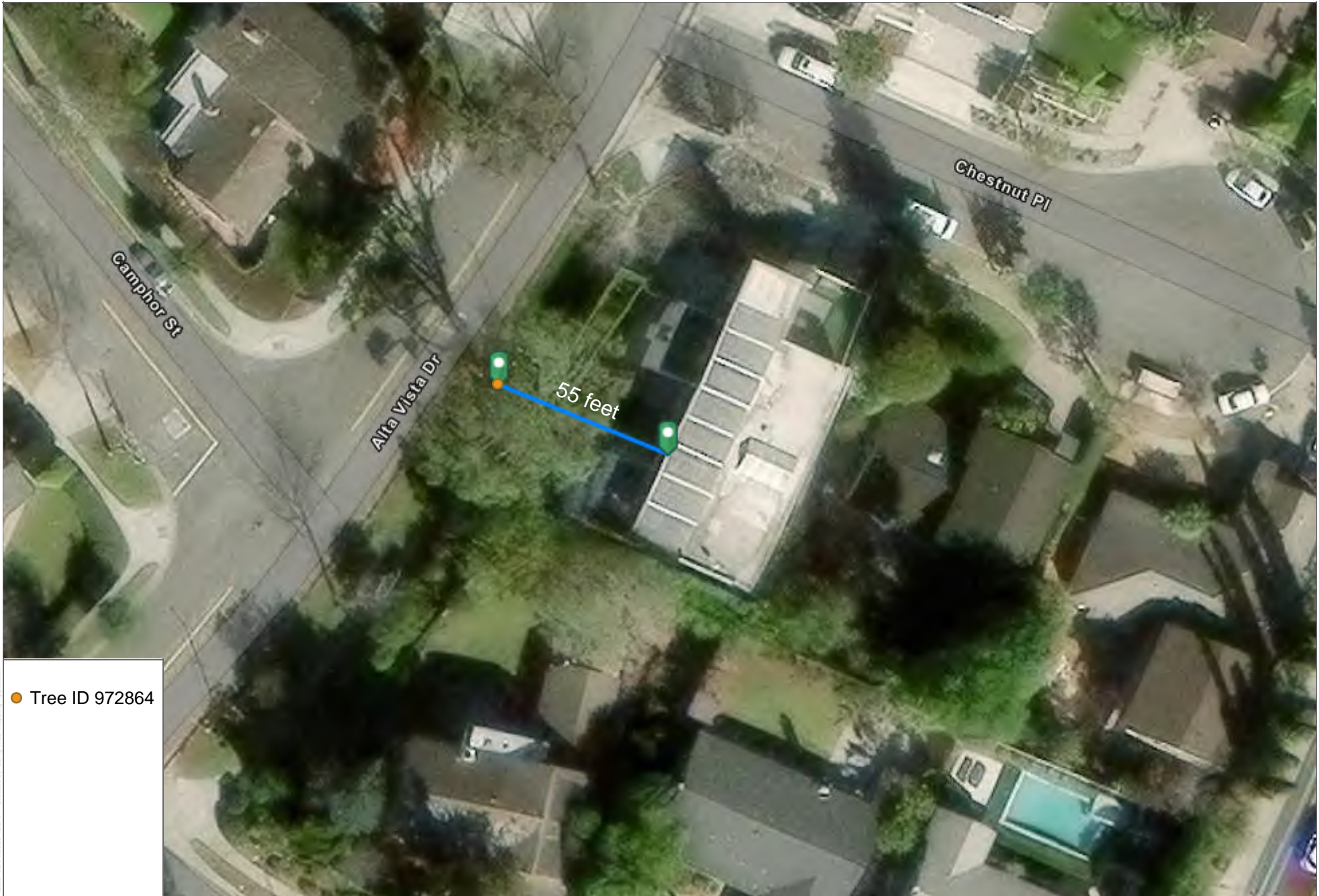

● Tree ID 972864

SOURCE: Dudek



Figure 1
Tree Location Exhibit
901 Chestnut Place



View of Tree ID 972864 facing northeast



View of Tree ID 972864 facing east



View of Tree ID 972864 facing southwest



View of Tree ID 972864 in proximity to 901 Chestnut Place



View of topping cuts Tree ID 972864



View of gall in crown of Tree ID 972864



View of old wound with heartwood decay and nesting cavity



View of repair gutter and asphalt street in proximity to Tree ID 972864



View of damaged and decayed roots



View of large damaged structural root



View of damaged 6 inch structural root



View of damaged structural roots



View of damaged roots



View of damaged 5 inch root



View of cavity on west side of root collar



Photo of cavity depth



Depth of cavity is approximately 6 inches



Proximity of sidewalk lifting (A) and replacement (B)

Topography, Microclimate and Soils: No information is provided. This information should be considered in the tree risk assessment process and discussed in the tree risk report. Factors such as slope, wind, and soil condition can affect the tree or tree part's likelihood of failure or the likelihood of impacting a target.

Existing Conditions: Dudek's site visit confirmed large structural roots on all sides of the tree have been previously damaged. Roots measuring as large as 6 inches appear to have been cut, and contrary to the Arborist Report are now exhibiting signs of decay. Upon further inspection, the void described in the Arborist Report, is actually a cavity in the root collar measuring approximately 6 inches deep when probed. The Dudek arborist did not observe included bark in any of the branch unions, though galls were observed in two locations.

Peer-Review of Methods

Level II Basic Tree Risk Assessment. The Arborist Report provides sufficient context defining the parameters of the risk assessment objectives and communication flow though does not adequately describe how the risk was evaluated or provide inspection limitations. The level of tree risk described in the Arborist Report is not framed within a time period. According to the ISA BMPs for Tree Risk Assessment, the time frame is the length for which the assessor is deciding whether or not a specific failure is likely to occur. A time frame must be defined before assessing the likelihood of failure, and without a time frame, the rating for likelihood of failure has no context and should be considered void. The Arborist Report describes the target as the residents inside the home at 901 Chestnut Place, however, the Risk Assessment Matrix on page 12 of the Arborist Report shows the target as the residence. This inconsistency deviates from the guidance provided in the ISA BMPs for Tree Risk Assessment for assessing the likelihood of failure and impact. The value of potential damage to the residence was assessed and categorized in accordance with the ISA BMPs for Tree Risk Assessment.

Level III Advanced Assessment. The Arborist Report does not provide adequate information regarding the methodology of the Level III Advanced Assessment using ground penetrating radar or context for selected locations of assessment. The depth and size categories of the root morphology were provided. However, the size categories were not assigned root diameter ranges. Limitations of technology used for advanced assessments should be clearly defined so that the tree owner can make informed tree management decisions. Root detections were only inspected on one side of the tree, even though cut roots were observed in multiple locations. This provides an incomplete estimation of the subject tree's root morphology.

Peer-Review of Tree Management Recommendations

The Arborist Report provides the overall risk rating, prioritized tree management recommendations, and a recommended inspection interval. Residual risk ratings were not provided for each of the tree management recommendations. Without residual risk ratings, the owner of the tree (City) cannot make an informed decision regarding the risk mitigation recommendations.

References

International Society of Arboriculture (ISA). 2017. *Best Management Practices: Tree Risk Assessment* (2nd ed.). Champaign, IL: International Society of Arboriculture.

Tree Care Industry Association (TCIA). 2023. *ANSI A300 Tree Care Standards: Part 13—Tree Risk Assessment*. Londonderry, NH: Tree Care Industry Association.

Arborist Report
Louis M. Hernandez Jr.
ISA Certified Arborist # WE-13022A

March 31, 2026

SITE INFORMATION:

Mr. Geoffrey Darby
901 Chestnut Pl.
Newport Beach, CA 92660

BACKGROUND AND ASSIGNMENT:

I was contacted to inspect a *Eucalyptus viminalis* growing in the city parkway adjacent to residence's property. The homeowner was concerned about the tree's size and relative location to his home. He had become aware that trees of this type had recently been involved in failures that caused severe property damage and even one death to a motorist. I was initially hired to perform a Level I inspection and a report.

The City of Newport Beach then asked Mr. Darby to hire an arborist to perform a risk assessment of the tree based on a level III Advanced Inspection. They recommended he either perform air spading or ground penetrating radar root mapping. Mr. Darby asked me to provide that requested report and Ground Penetrating Radar mapping.

GENERAL SITE OBSERVATIONS:

The subject tree is approximately 80 ft. tall and appears to be well maintained. The tree is growing approximately 60 lf. from the dwelling. The area of the dwelling closest to the subject tree is the residence's living quarters, the den, bedroom and kitchen. The subject tree is growing in a parkway area that is covered in synthetic turf except where the tree exists. There appears to be no irrigation system for the subject tree. The tree has a DBH of 4'. The tree has a normal root flair except for large surface roots that have been cut within 2' of the edge of the trunk base. (see Attachment A – Photo 1) There is no mulch covering over the root flair. The cut roots appear, upon visual inspection to be properly healed. There is a large void on the street side of the root flair, but no visible injury that could have caused the void. (see Attachment A – Photo 2) It appears that a portion of the city curb and gutter directly adjacent to the tree has been replaced. The new joint between the old and new curb and gutter has begun to be lifted. The tree's crown has been trimmed away from the residence and is visibly off balance towards the street side. (see Attachment – Photo 3)

The Canopy has some dead wood in its upper reaches and one of the main structural branches has a wound that is weeping. To create the crown into its unbalanced existence, the tree has evidence of topping. There appears to be included bark on the lower branch crotches. (See Attachment A - Photo 4)

LEVEL III TREE RISK ASSESSMENT:

Since the most concerning issue with this tree is the appearance of many large cut roots within two feet of the tree trunk, I decided to hire a Ground Penetrating Radar Technician to perform root mapping. Linear scans were performed on the root mass of the subject tree on the street side with four different scans taken. The results of the GPR Root Mapping are included in this report. (see Attachment B - Figures 1-7)

A Tree Risk Assessment Matrix of the subject tree was completed, with the target being the retired people living in the part of the residence closest to the subject tree, and because of the root mass damage and recovery of the subject tree on the opposite side of the subject tree from the residence, it was determined that the Risk Rating of this tree was HIGH. (see Attachment C - Matrix of Tree Risk Assessment)

CONCLUSIONS:

The results of the GPR show that few to no larger roots exist on the street side of the tree. Many small to medium roots exist as reaction growth as a result of the cutting and removal of the larger roots. The regrowth of roots and the existence of the large void in the root flare are supporting the health of the tree, but they may not be contributing adequately to the structural integrity and stability of the tree

The subject tree is relatively healthy and growing, however because of the absence of structural roots on the street side of the subject tree, the potential for catastrophic failure with potential harm to human life, living in the adjacent residence, and because this tree has little to no intrinsic value for the community where it exists, it is my opinion that this tree should be removed.

RECOMENDATIONS:

Tree removal at the earliest possible opportunity, to mitigate potential harm to humans.

If the tree is not removed, then reducing the height of the tree by removing at least 25% of its height, is highly recommended. Please note that this kind of severe trimming could potentially weaken or could also cause the decline of the subject tree. Therefore, if crown reduction is the ultimate remedy preferred by the owner of this tree, The City of Newport Beach, then 'drop crotching' of the tree is recommended as a means to lower the tree's height. This tree should then have yearly inspections by a Certified Arborist to assess the health of the tree.

ARBORIST'S DISCLAIMER: Arborists are tree specialists who use their education, knowledge, training and experience to examine trees, recommend measures to enhance the beauty and health of trees, and attempt to reduce the risk of living near trees. Clients may choose to accept or disregard the recommendations of the arborist, or to seek additional advice. Arborists cannot detect every condition that could possibly lead to structural failure of a tree or anticipate extreme weather events that could contribute to failure. Trees are living organisms that fail in ways we do not fully understand. Conditions are often hidden within trees and below ground. Arborists cannot guarantee that a tree will be healthy or safe under all circumstances, or for a specified period of time. Likewise, remedial treatments, like any medicine, cannot be guaranteed. Treatment, pruning and removal of trees may involve considerations beyond the scope of the Arborists services such as property boundaries, property ownership, site lines, disputes between neighbors, and other issues. Arborists cannot take such considerations into account unless complete and accurate information is disclosed to the arborist. An arborist should then be expected to reasonably rely upon the completeness and accuracy of the information provided.

Please contact me if you have any questions. Cell Phone: 714-720-3804

Sincerely,

Louis M. Hernandez Jr.
ISA Certified Arborist WE-13022A
Tree Risk Assessment Qualified

ATTACHMENT A – PHOTOS



PHOTO #1 – ARROWS INDICATE CUT ROOTS

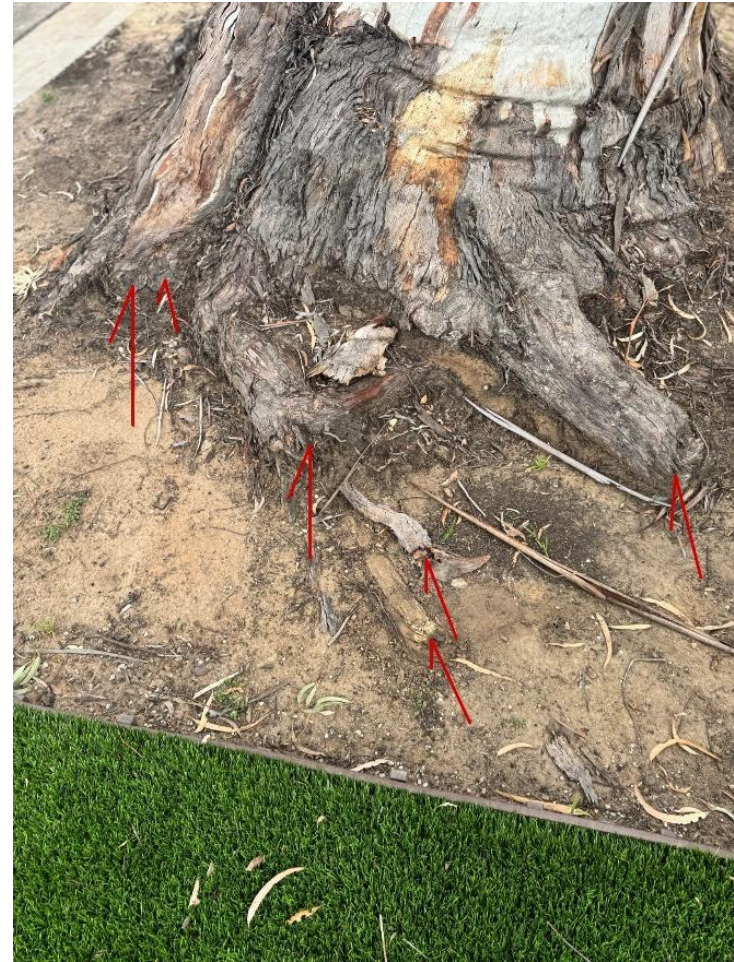

PHOTO #2 AAROWS INDICATE CUT ROOTS

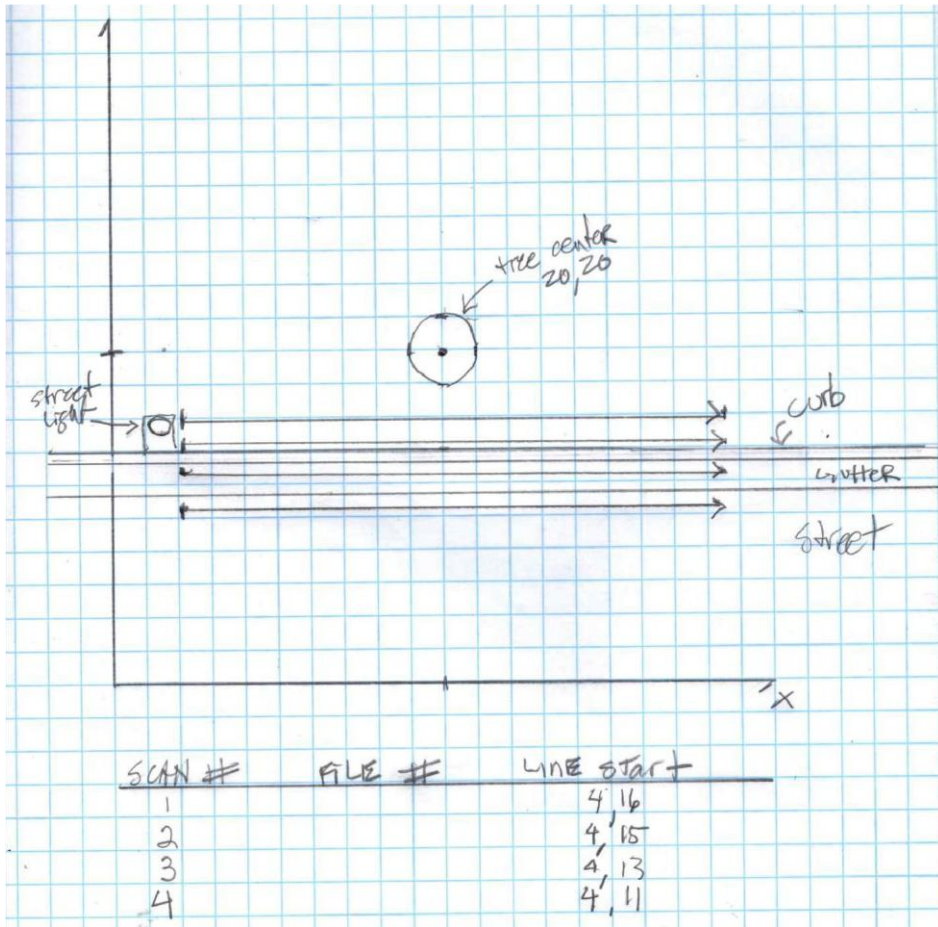

PHOTO #3 – UNBALANCED TREE CANOPY



PHOTO #4 – INCLUDED BARK ON LOWER CROTCH

ATTACHMENT B



Site sketch of project area

Based on X, Y coordinates



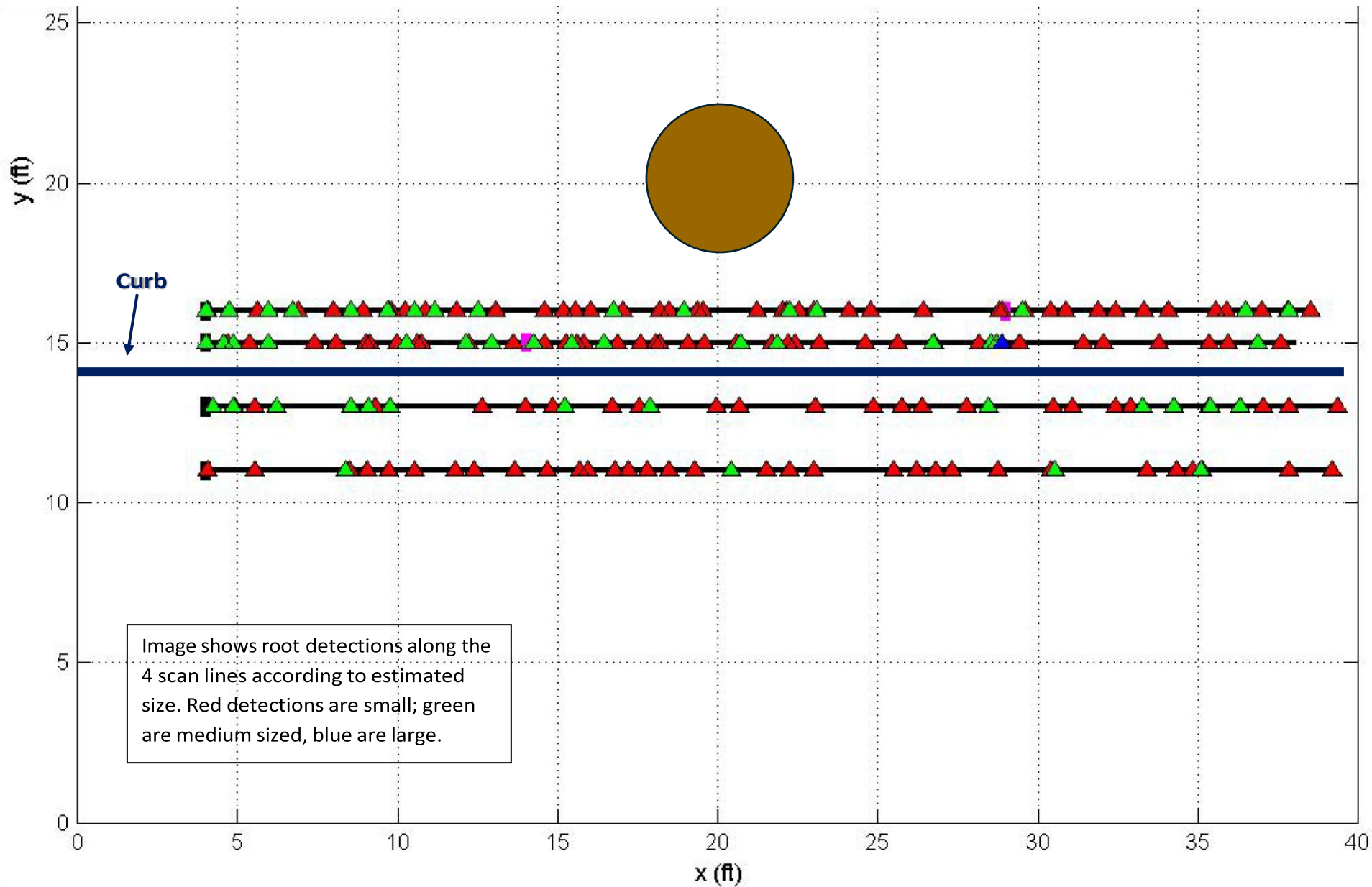

Top-Down View of Root Detections

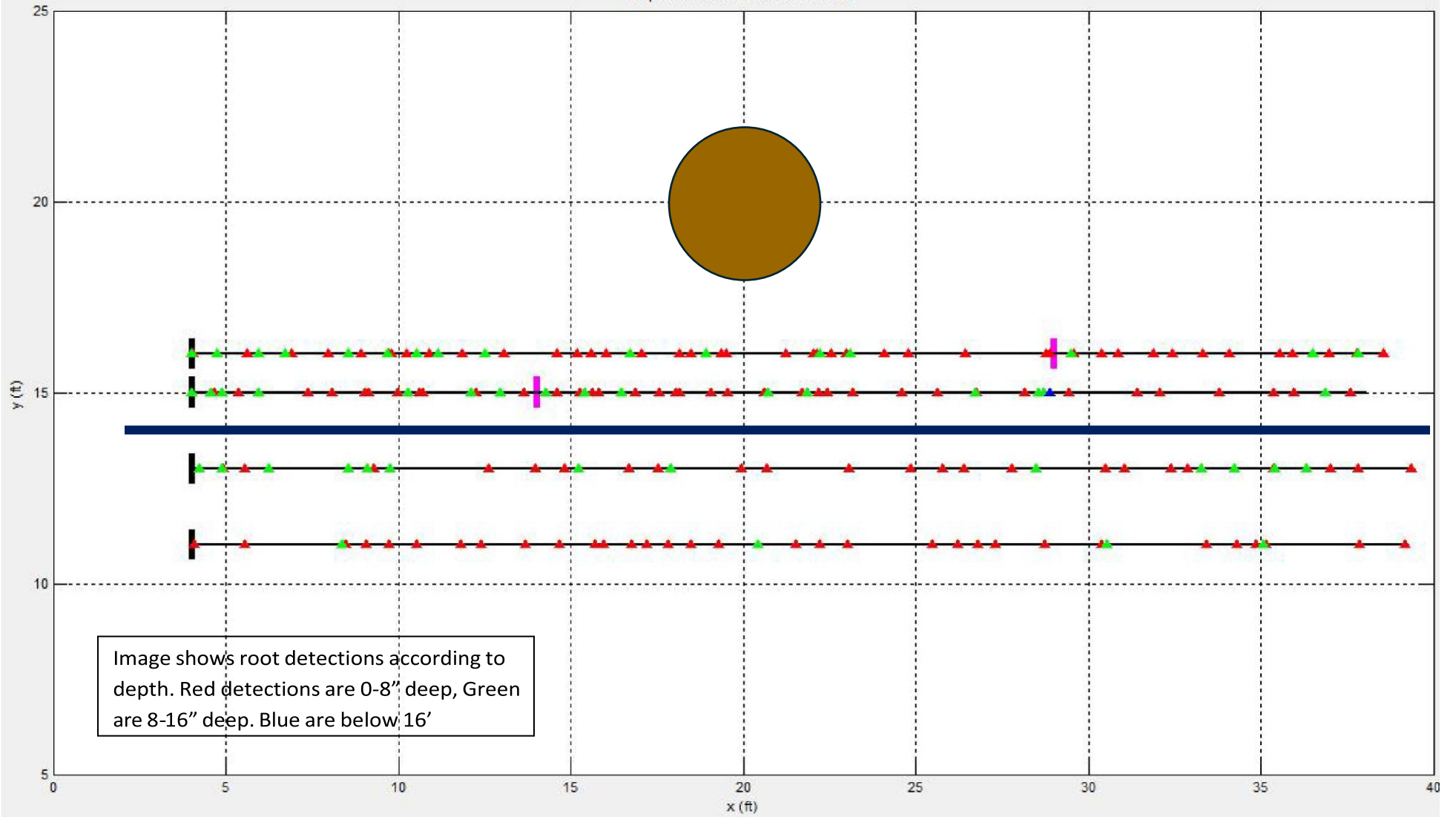

Top-Down Root Density Map

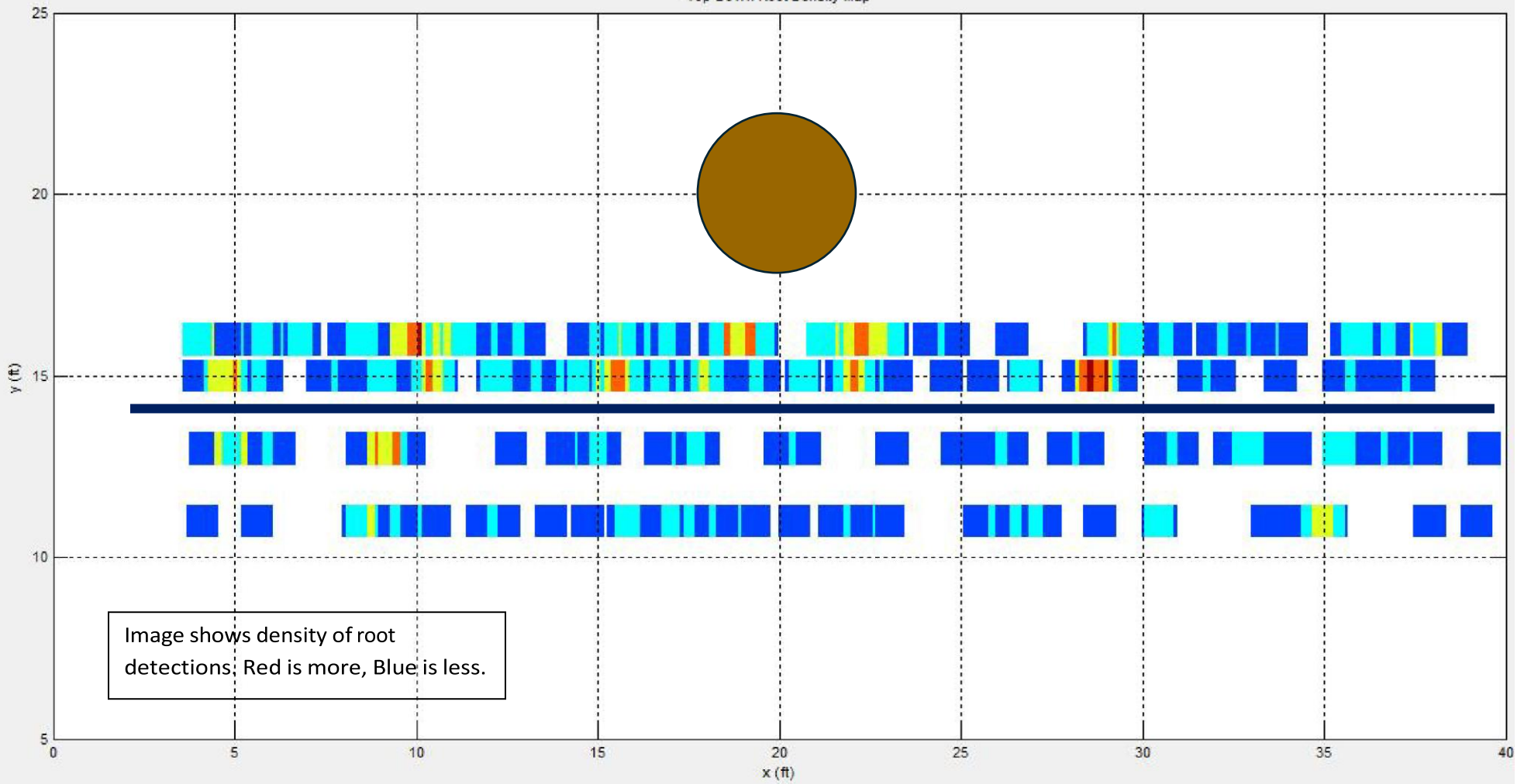

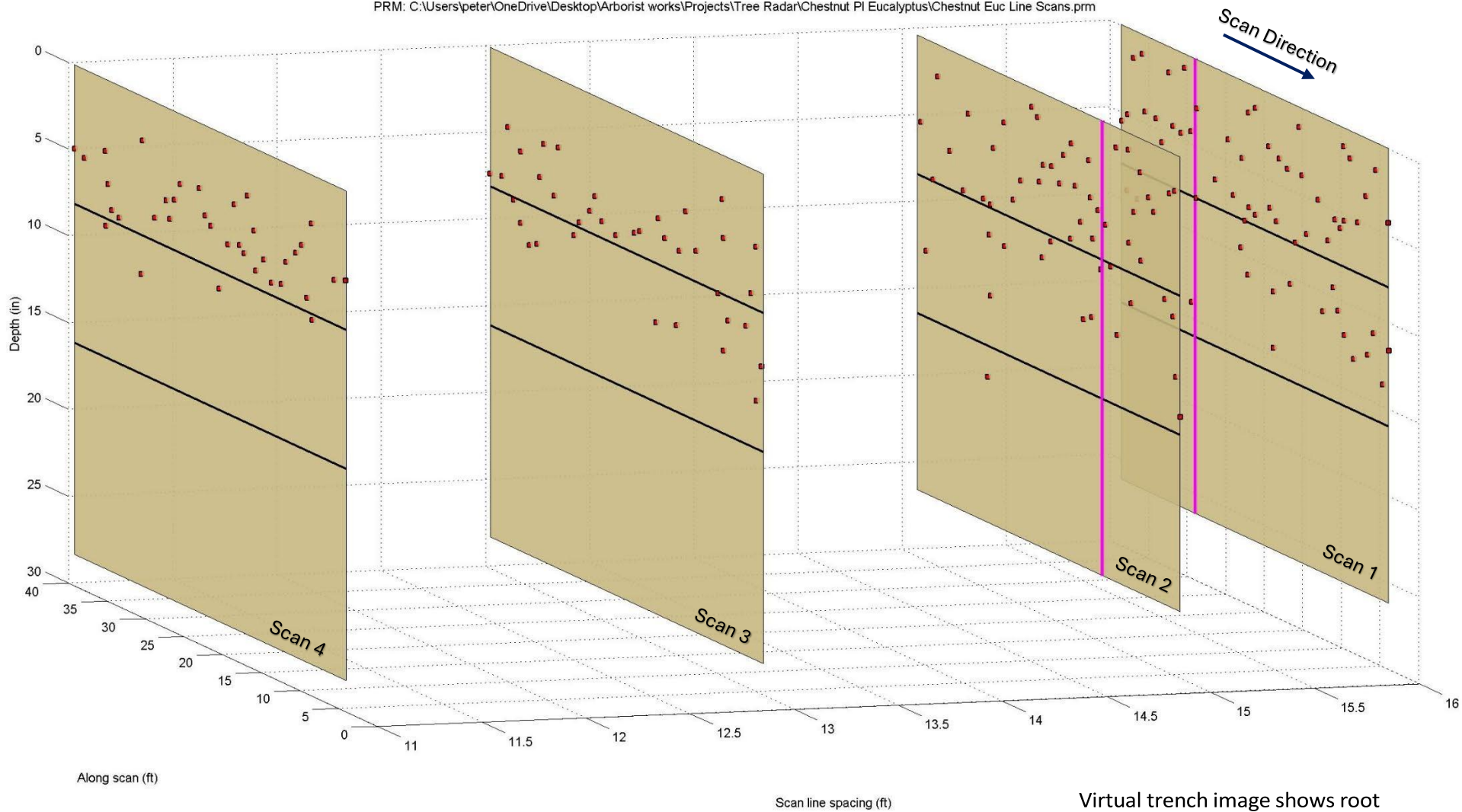

Virtual trench image shows root detections within a vertical plane for each scan line.

Root Morphology Map

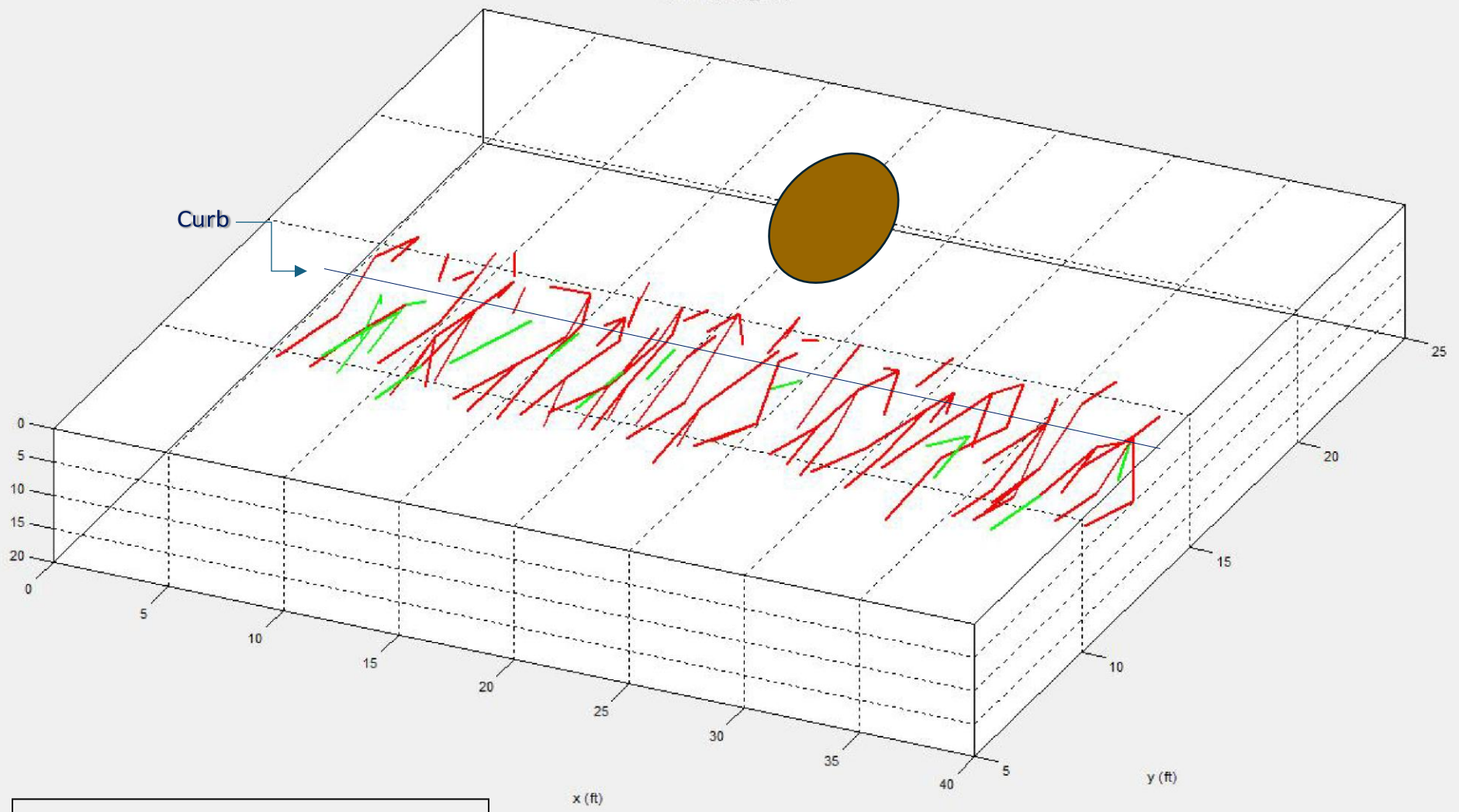

Image shows possible root morphology based on estimated root depth. Red is 0-8" deep, Green is 8-16" deep, Blue is below 16'

MORPHOLOGY: Red = Depth Zone 1, Green = Depth Zone 2, Blue = Depth Zone 3

Root Morphology Map

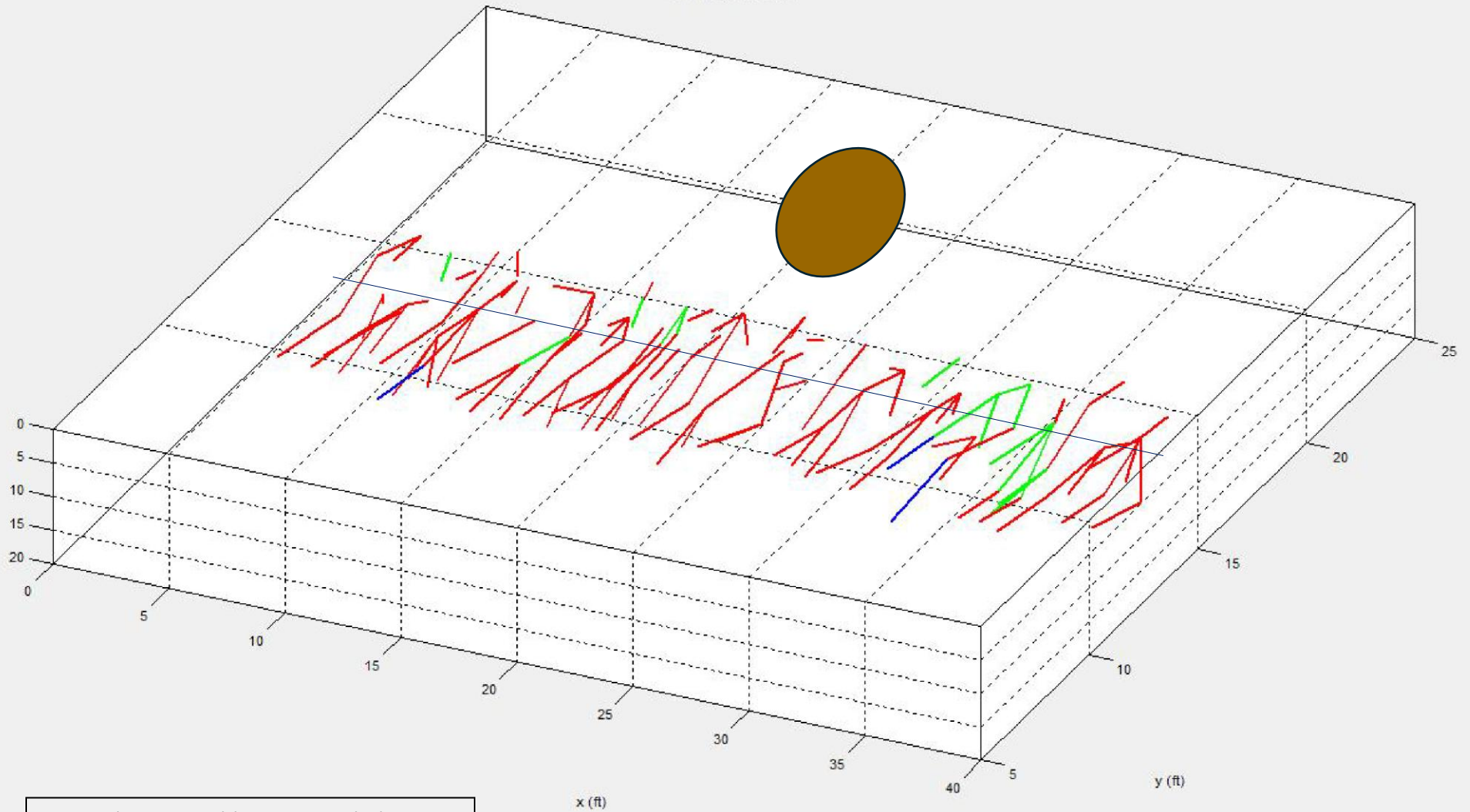

Image shows possible root morphology based on estimated root size. Red is small; green is medium sized, blue is large

MORPHOLOGY: Red = Estimated Small, Green = Estimated Medium, Blue = Estimated Large



City of Newport Beach: Trees Section – Tree Info Sheet

Jacaranda tree (*Jacaranda mimosifila*)

Jacaranda mimosifolia is a spectacular tree, native to the tropical regions of Bolivia and Argentina and has been cultivated in almost every part of the world where there is no risk of frost. It produces clusters of fragrant purple panicle-shaped blooms in the late-spring and again in autumn and its branches are arched, forming a canopy shaped like an upturned umbrella. The jacaranda tree makes an excellent shade (or street) tree with its fern-like leaves that can grow up to 20 inches in length. It was imported into Southern California by the horticulturalist Kate Sessions in the early 20th Century.

Description:

Has partly deciduous foliage

Height: 40 feet

Spread: 15 to 30 feet

Crown shape:

Rounded

Growth rate:



36-inch per year

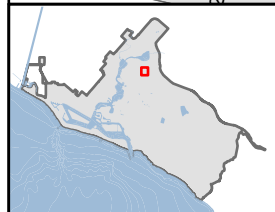
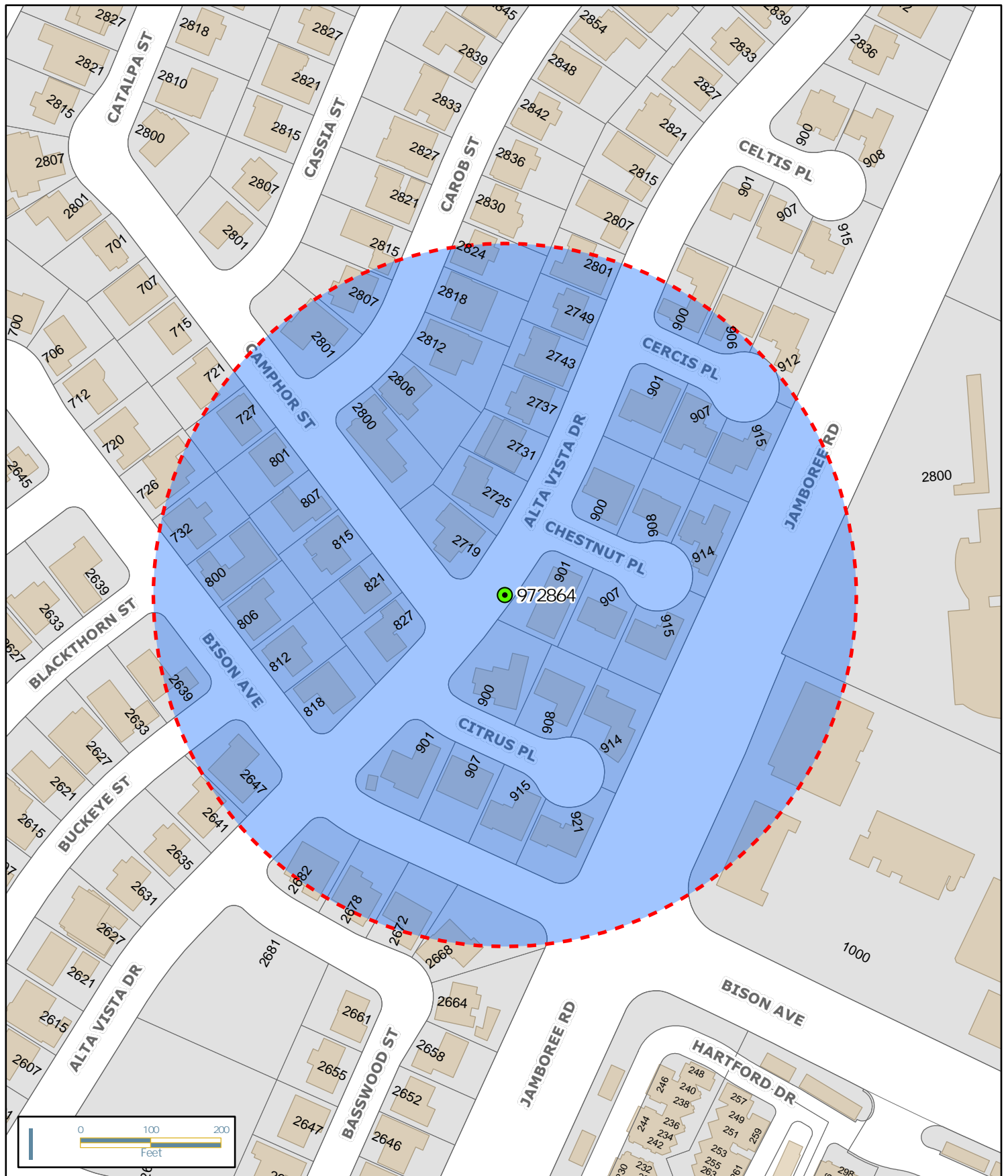



Tree Reforestation

901 Chestnut Pl

-  Tree Location
-  Properties Notified
-  500 ft



City of Newport Beach
GIS Division
May 14, 2026